



Hampton Court Mews, Feltham Avenue, Hampton Court, KT8

£345 Per week

For further information,
please call our Park Road
Branch on 0207 586 6699

This is a bright and modern two double bedroom apartment on the first floor of this delightful residential development situated by the Thames River Bank and within five minutes walk to Hampton Court Palace. The property comprises of: Entrance hallway, spacious open plan lounge/dining room with an integrated fitted kitchen, leading out onto a lovely private balcony overlooking communal terrace. Two double bedrooms each with good storage, bathroom/Wc. and one secure underground parking space. The property is offered furnished and is available 9th April for long let.

Accommodation

This is a bright and modern two double bedroom apartment on the first floor of this residential development situated right on the River Thames

£345

Benefits

- Two Double Bedrooms
- First Floor
- Secure underground parking
- Private Balcony
- Close to River Thames and
- Hampton Court Palace

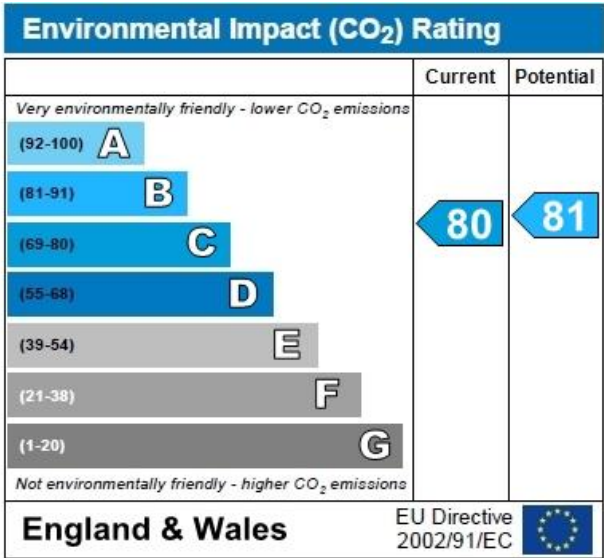
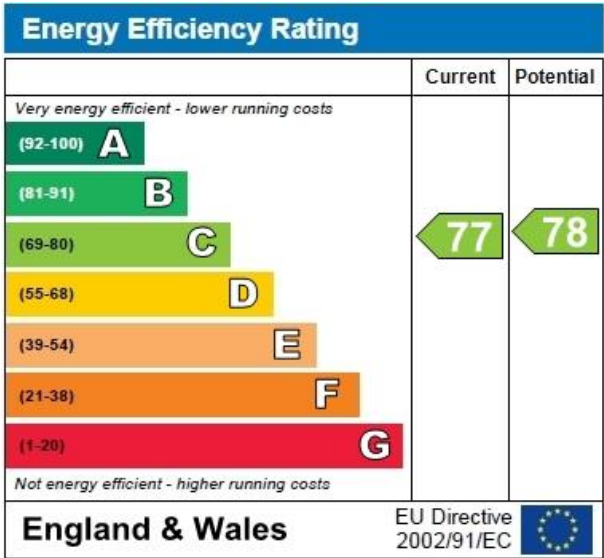

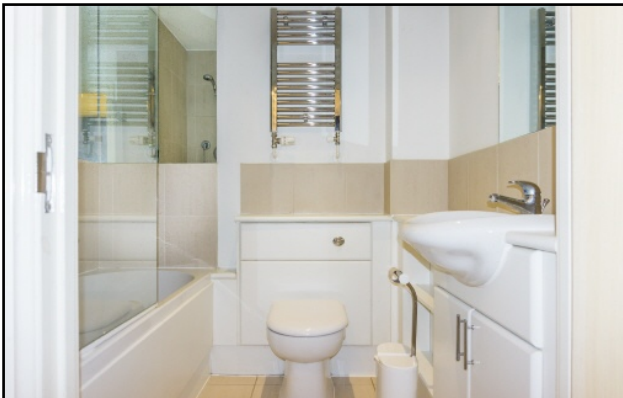

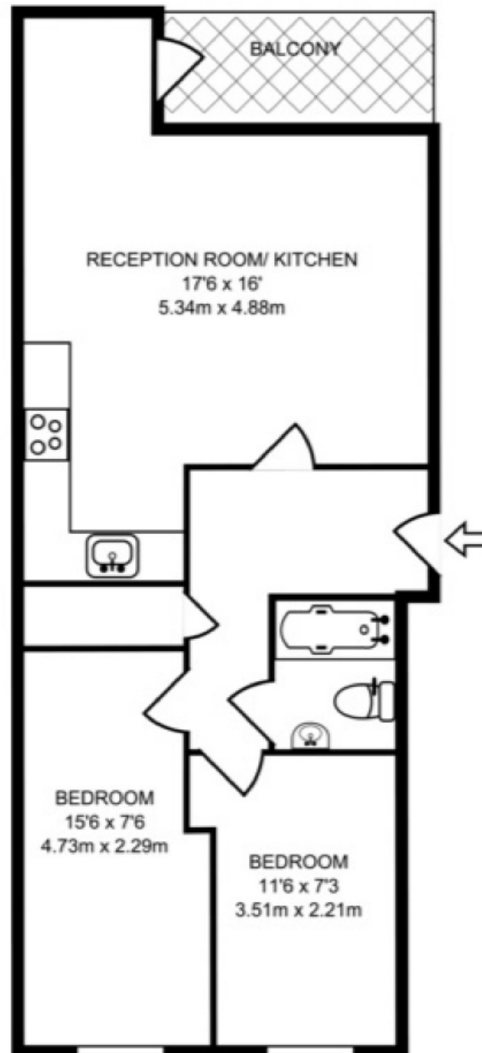

GROSS INTERNAL FLOOR AREA
 570 SQ FT/52.95 SQ M

Representation of current layout, gross internal floor area is approximately 570 Sq Ft (52 Sq M)