

KINGS

Sales Lettings Management



Byng Drive, Potters Bar, Hertfordshire, EN6 1UH

£635,000



- LINK SEMI-DETACHED BUNGALOW
- TWO BATHROOMS
- KITCHEN/DINER
- CLOSE TO SHOPS AND AMENITIES
- FREEHOLD
- FOUR BEDROOMS
- LIVING ROOM
- LARGE GARDEN
- SOUGHT AFTER LOCATION
- EPC RATING - E





Located in a highly sought after area is this well presented, four bedroom semi-detached chalet bungalow. The property comprises an inviting entrance hall with oak wood flooring, spacious living room with curved bay window and working fireplace, large kitchen/diner with central island and study area, master bedroom with fitted wardrobe, second double bedroom and family bathroom with under-floor heating. The converted loft features one double bedroom, one single bedroom and another bathroom also with under-floor heating. This property further benefits from a large garden, off street parking for up to four cars and is within walking distance to many local shops and amenities including Oakmere Park and Potters Bar train station.



Byng Drive
 Approx. Gross Internal Area *
 1207 Ft² - 112.13 M²

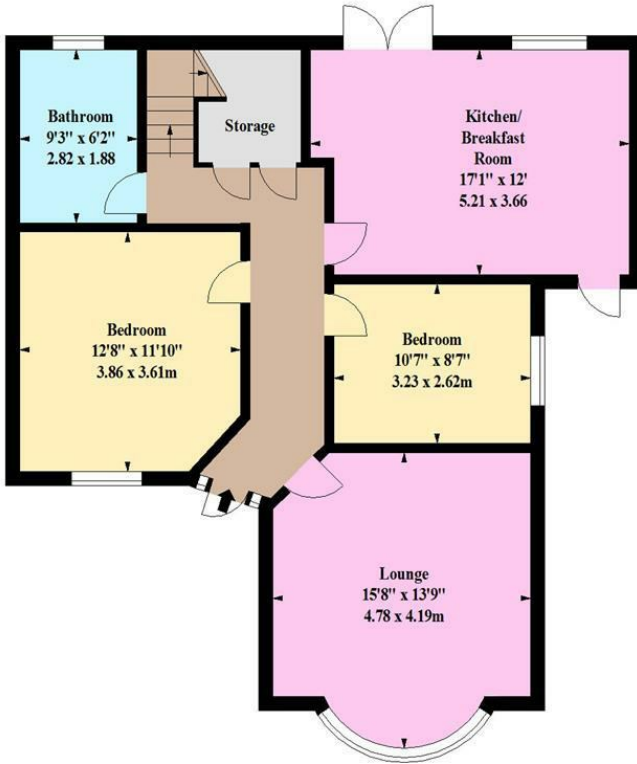

Ground Floor

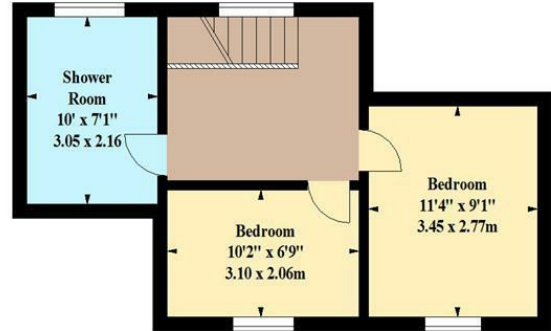

Loft

Whilst every attempt has been made to ensure the accuracy of the floor plan contained here, measurements of doors, windows, rooms and any other items are approximate and no responsibility is taken for any error, omission or mis-statement. This plan is for illustrative purposes only and should be used as such by any prospective purchaser. The services, systems and appliances shown have not been tested and no guarantee as to their operability or efficiency can be given

