



27 The Chilterns, Stevenage

£1,100 Per calendar month

Welcoming to the market this Three Bedroom End Of Terrace Home set within Great Ashby & within Walking Distance to the Local Excellent Rated Primary School. Internally the property comprises of; An Entrance Porch, Downstairs Cloakroom, Lounge, Dining Room & Kitchen. Upstairs you will find Three Bedrooms with Family Bathroom. Outside you have a Private Rear Garden and a Garage & Driveway to the front. AVAILABLE NOW, viewing comes highly recommended!



27 The Chilterns, Stevenage

Accommodation Comprises Of:

Entrance Hallway

Downstairs Cloakroom

Lounge 14'6 x 14'8 (4.42m x 4.47m)

Dining Room 7'4 x 11'5 (2.24m x 3.48m)

Kitchen 6'2 x 11'4 (1.88m x 3.45m)

Stairs To First Floor Landing

Bedroom 1: 11'7 x 8'7 (3.53m x 2.62m)

Bedroom 2: 10'5 x 6'3 (3.18m x 1.91m)

Bedroom 3: 7'4 x 7'3 (2.24m x 2.21m)

Family Bathroom

Private Rear Garden

Garage & Driveway





Ground Floor

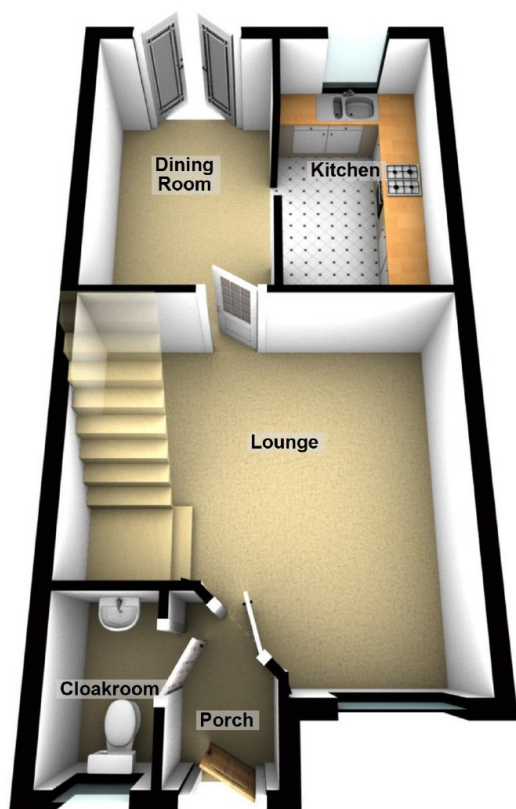

First Floor

