



## Stainer Road

Borehamwood, WD6

- 3 Bedrooms
- Spacious Kitchen
- Living/Dining Room
- Family Bathroom
- End of Terrace
- Quiet Location
- Front Garden
- Private Rear Garden

Guide Price of £399,950



T: 01923 537 111





A well presented three bedroom end of terrace family house situated in a quiet close, just off Theobald Street and a short drive from Borehamwood Town Centre and Mainline Station. The property comprises: entrance hall, a large fully fitted kitchen, spacious living/dining room, two double bedrooms, further single bedroom and family bathroom. Externally there is a front garden and a pretty rear garden with patio area and wooden storage shed.

### **FAMILY BATHROOM**

8' 2" x 5' 7" (2.49m x 1.7m)

### **EXTERIOR**

#### **FRONT GARDEN**

Area of lawn bordered by small apple trees.

#### **REAR GARDEN**

Patio leading to area of lawn bordered by a flower bed to rear, large wooden storage shed and side access.

### **GROUND FLOOR**

#### **ENTRANCE HALL**

#### **LIVING/DINING ROOM**

21' 8" x 10' 4" (6.6m x 3.15m)

#### **KITCHEN**

12' 5" x 10' 5" (3.78m x 3.18m)

### **FIRST FLOOR**

#### **LANDING**

#### **BEDROOM ONE**

11' 11" x 11' 5" (3.63m x 3.48m)

#### **BEDROOM TWO**

12' 6" x 8' (3.81m x 2.44m)

#### **BEDROOM THREE**

10' 6" x 6' 10" (3.2m x 2.08m)

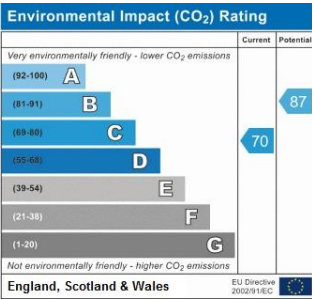
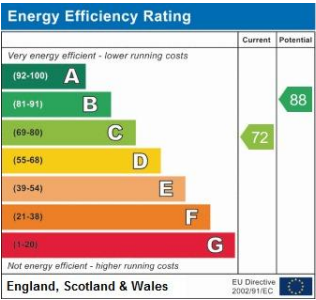

**COUNCIL TAX BAND**

Tax band D

**TENURE**

Freehold

**LOCAL AUTHORITY**

Hertsmere Borough Council





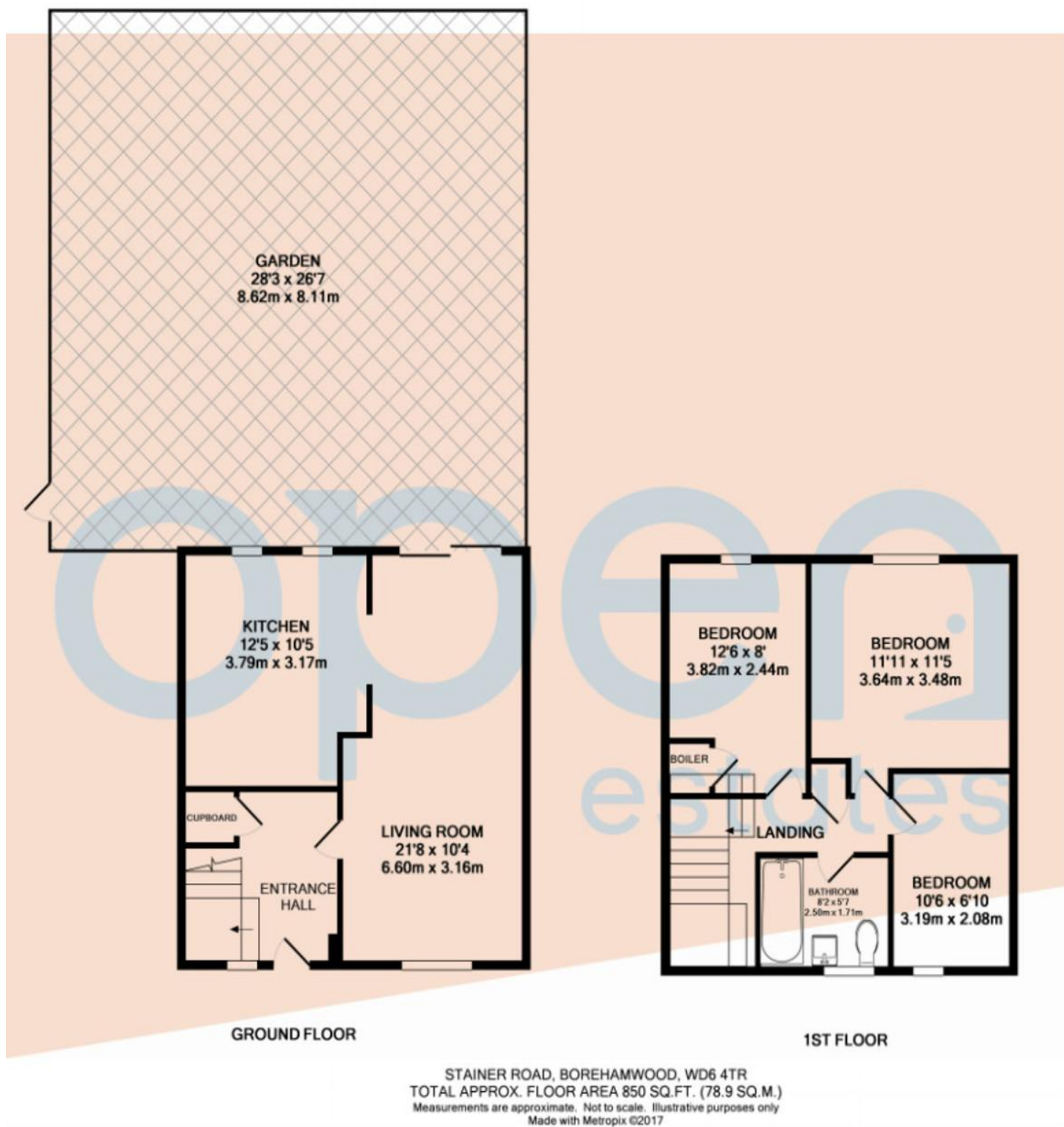

**OFFICE**

54 Watling Street  
Radlett  
Hertfordshire  
WD7 7NN

**T:** 01923 537 111

**E:** [info@openestates.co.uk](mailto:info@openestates.co.uk)

**W:** [www.openestates.co.uk](http://www.openestates.co.uk)

Agents Note: Whilst every care has been taken to prepare these sales particulars, they are for guidance purposes only. All measurements are approximate are for general guidance purposes only and whilst every care has been taken to ensure their accuracy, they should not be relied upon and potential buyers are advised to recheck the measurements