



Slade Court

Watling Street, Radlett, WD7

Guide Price £325,000

- Ground Floor Retirement Living
- One Double Bedroom
- Disabled Friendly Shower Room
- Living/Dining Room
- Fitted Kitchen
- One Parking Space
- Communal Gardens
- Central Radlett Location



T: 01923 537 111



A well presented one bedroom ground floor warden controlled apartment directly off Radlett village high street and benefitting from access straight onto the communal gardens from the living room.

The accommodation comprises;- hallway with two double fitted storage cupboards, living/dining room, fitted kitchen, double bedroom with built in wardrobe, disabled friendly shower room and new carpets through-out. There is also parking for one vehicle and the property is offered chain free.

ENTRANCE HALL

LIVING/DINING ROOM

11' 8" x 15' 1" (3.56m x 4.6m)

KITCHEN

7' 10" x 10' 3" (2.39m x 3.12m)

BEDROOM

9' 3" x 15' 1" (2.82m x 4.6m)

DISABLED FRIENDLY SHOWER ROOM

EXTERIOR

COMMUNAL GARDENS

PERMIT PARKING

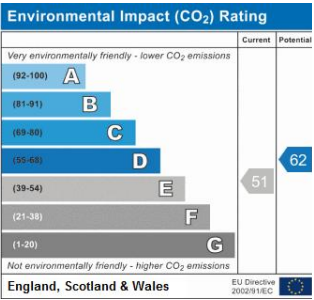
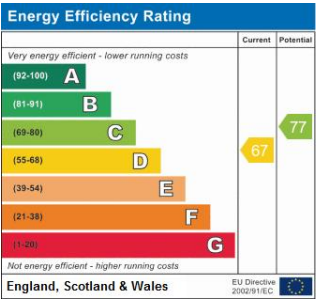

COUNCIL TAX BAND

Tax band

TENURE

Leasehold

LOCAL AUTHORITY

Hertsmere Borough Council

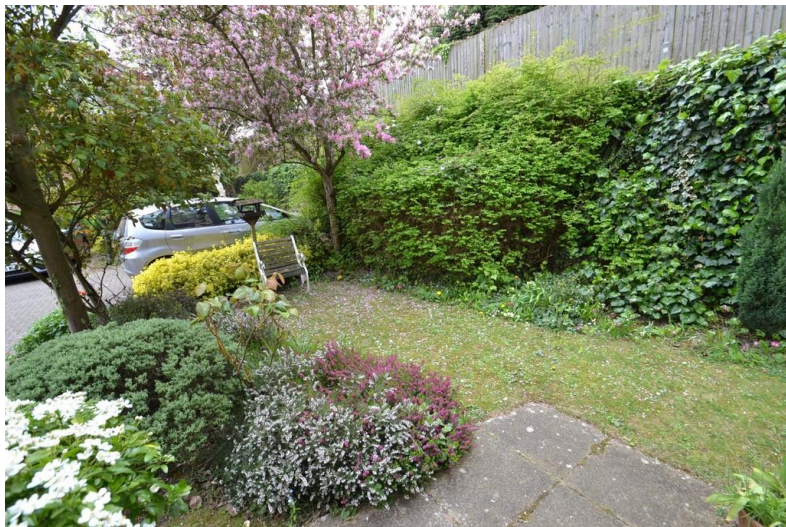

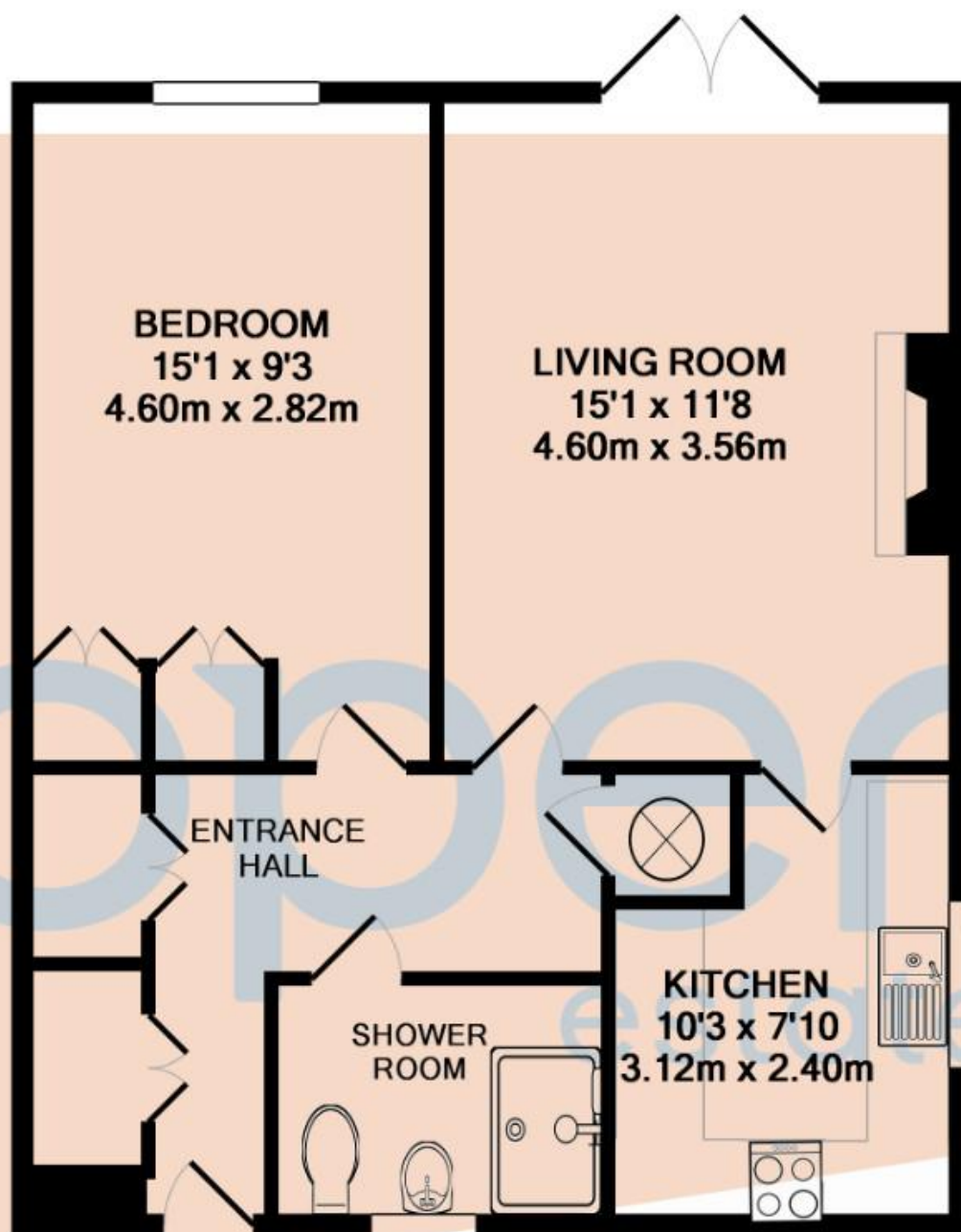

TOTAL APPROX. FLOOR AREA 555 SQ.FT. (51.6 SQ.M.)
 Measurements are approximate. Not to scale. Illustrative purposes only
 Made with Metropix ©2017

OFFICE

54 Watling Street
 Radlett
 Hertfordshire
 WD7 7NN

T: 01923 537 111

E: info@openestates.co.uk

W: www.openestates.co.uk

Agents Note: Whilst every care has been taken to prepare these sales particulars, they are for guidance purposes only. All measurements are approximate and for general guidance purposes only and whilst every care has been taken to ensure their accuracy, they should not be relied upon and potential buyers are advised to recheck the measurements