

Orde Hall Street, Bloomsbury, WC1N



This two bedroom first floor flat is located on a quiet residential street close to Lamb's Conduit Street and Queen Square Gardens.

The flat is comprised of a west facing reception that gets the late afternoon and evening sun, a good sized master bedroom with built in wardrobes set at the rear of the flat, a second bedroom that leads off the reception and is also west facing, a separate good sized modern kitchen with integrated appliances and a modern shower room. The flat is over 600 sq. ft. and has high ceilings and attractive sash windows throughout that allow a lot of natural light.

Fantastically located, Orde Hall Street is close to the restaurants, boutiques and bars of fashionable Lamb's Conduit Street, the tranquil Queen Square Gardens and Great Ormond Street Hospital. Also, within walking distance is all that Bloomsbury has to offer; Russell Square, Coram's Fields, the Brunswick Centre, Bloomsbury Square Garden and the British Museum as well as Covent Garden and Holborn to the south and King's Cross and St Pancras to the north. The nearest tube stations are Russell Square (Piccadilly) and Holborn (Central and Piccadilly).

A fantastic home or investment property close to a large hospital and UCL and SOAS.

£650,000 Leasehold



Orde Hall Street, WC1N 3JW

Approx. Gross Internal Area 612 Sq Ft - 56.86 Sq M

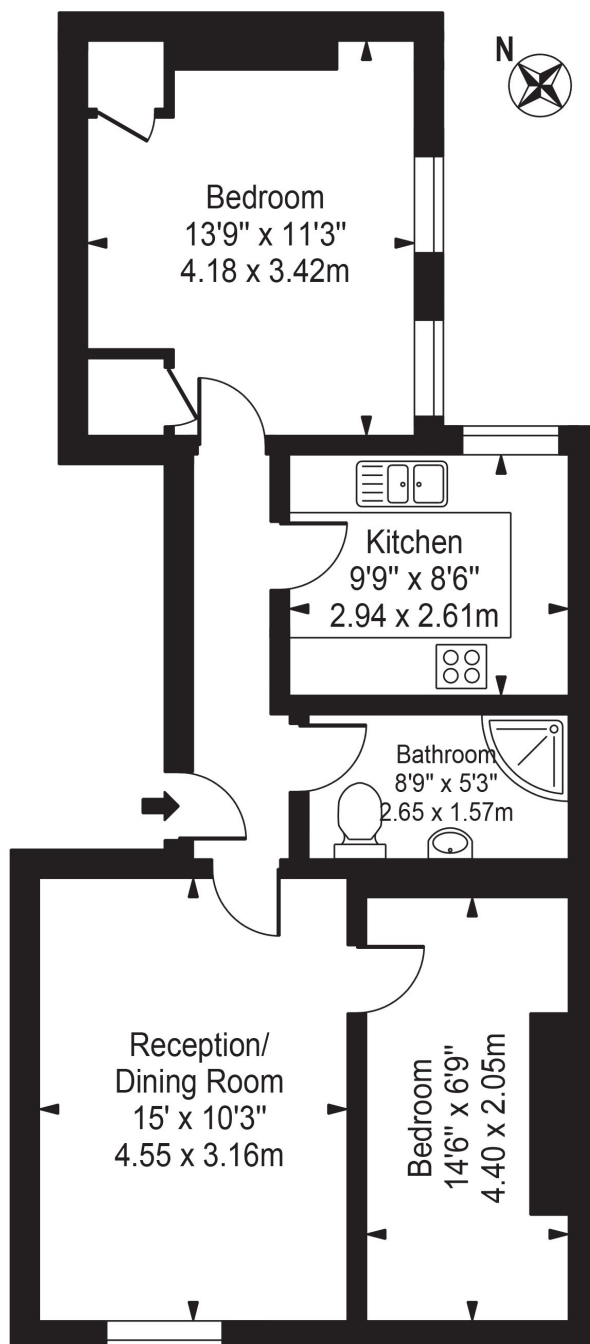

First Floor

For Illustration Purposes Only - Not To Scale

This floor plan should be used as a general outline for guidance only and does not constitute in whole or in part an offer or contract. Any intending purchaser or lessee should satisfy themselves by inspection, searches, enquiries and full survey as to the correctness of each statement. Any areas, measurements or distances quoted are approximate and should not be used to value a property or be the basis of any sale or let.







Tenure: Leasehold—94 years remaining

Service charge: £538.07

Ground rent: TBC

EPC rating: E

Local authority and council tax band: LB of Camden, Band D, £1,489 PA

Price: £650,000

Contact: Thomas Michael, 10th floor, 88 Wood Street, EC2V 7RS

020 7060 0450

sales@thomasmichael.co.uk

Thomas Michael (and their joint agents where applicable) and the vendors or lessors of this property give notice that: (a) these particulars are a general outline only, for the guidance of prospective purchasers or tenants, and do not constitute the whole or any part of an offer or contract; (b) Thomas Michael cannot guarantee the accuracy of any description, dimensions, references to condition, necessary permissions for use and occupation and other details contained in these particulars and prospective purchasers or tenants must not rely on them as statements of fact or representations and must satisfy themselves as to their accuracy; (c) no employee of Thomas Michael (and their joint agents where applicable) has any authority to make or give any representation or warranty or enter into any contract whatever in relation to the property; (d) prices, rents and premiums quoted in these particulars may be subject to VAT in addition: and (e) Thomas Michael will not be liable, in negligence, for any loss arising from the use of these particulars.