



Neal Close, Plympton, Plymouth



41 Neal Close, Plympton, Plymouth, PL7 1YY

Property Description

Situated in a popular cul-de-sac with off road parking and garden is this well presented two bedroom house in the Yealmpstone Farm area of Plympton. Accommodation comprises lounge/diner, modern kitchen, two double bedrooms and a modern bathroom. Benefits include gas central heating, uPVC double glazing, allocated parking and an enclosed rear garden.



PRICE : £149,950

PORCH::

LOUNGE/DINER: 17' 4" x 11' 2" (5.30m x 3.42m)

KITCHEN: 11' 1" x 10' 1" max (3.38m x 3.08m max)
uPVC double glazed window to the rear and double glazed door to the same. Wall and floor mounted matching units with roll edge worktops and tiling to splash back areas. Built in stainless steel oven with gas hob over and extractor over and spaces for washing machine, fridge and freezer. Radiator and door to storage cupboard.

FIRST FLOOR LANDING:

BEDROOM 1: 11' 3" x 11' 2" (3.44m x 3.42m)

BATHROOM: Suite comprising panelled bath with shower over, wash hand basin with cupboards under and low flush W.C. Tiling to splash back areas and to shower area.

BEDROOM 2: 11' 2" x 7' 2" (3.41m x 2.19m)

OUTSIDE: To the front of the property is a garden laid mainly to lawn with a central path leading to the front door. Further to the front there is an allocated parking space. To the rear is a good size garden with a patio area leading onto a lower lawn area which in turn leads to a 2nd lawned garden area.



Ground Floor

Approx. 30.0 sq. metres (322.5 sq. feet)

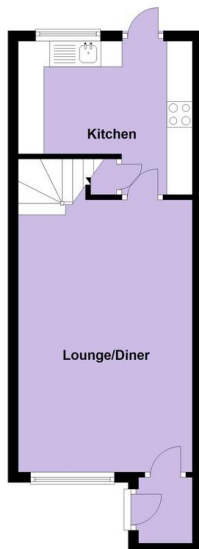

First Floor

Approx. 28.5 sq. metres (306.7 sq. feet)



Total area: approx. 58.5 sq. metres (629.2 sq. feet)

EPC Rating - C
Council Tax Band - B

Viewing Arrangements:
Contact Moving On
01752 340666

For more information
on this property
please visit our
website

www.movingonestateagents.co.uk

Important Note: These details have been produced for prospective purchasers as a guide only. This includes floorplans that may not be to scale but are provided as a guide to layout only. They are not part of a contract or offer and should not be relied upon as a statement of fact. No appliances, central heating or electrical systems have been tested. Prospective purchasers should make their own enquiries.



Zoopla.co.uk



01752 340666

145 Ridgeway, Plympton, Plymouth, PL7 2HJ
www.movingonestateagents.co.uk

