



**BRADFORD  
& HOWLEY**  
HARPENDEN | MARSHALSWICK | ST ALBANS

The Ridgeway, St. Albans, AL4 9XA  
Asking Price £850,000



A Nash built three-bedroom semi-detached family home, set on a wide plot of approximately 0.10 acres and offering excellent scope to extend STPP.

The property is situated within walking distance of SANDRINGHAM SCHOOL, plus a short walk also to SKYSWOOD PRIMARY SCHOOL, and offers spacious and versatile living arranged over two floors with two large reception rooms and a kitchen to the ground floor and three bedrooms and two bathrooms to the first floor.

Externally the property offers a private rear garden with gated side access leading to parking for several vehicles and a single garage.

**Tenure: Freehold**  
**Council Tax Band: E**  
**EPC Rating: D**















## Ground Floor

Approx. 50.6 sq. metres (544.9 sq. feet)



## First Floor

Approx. 47.3 sq. metres (509.6 sq. feet)

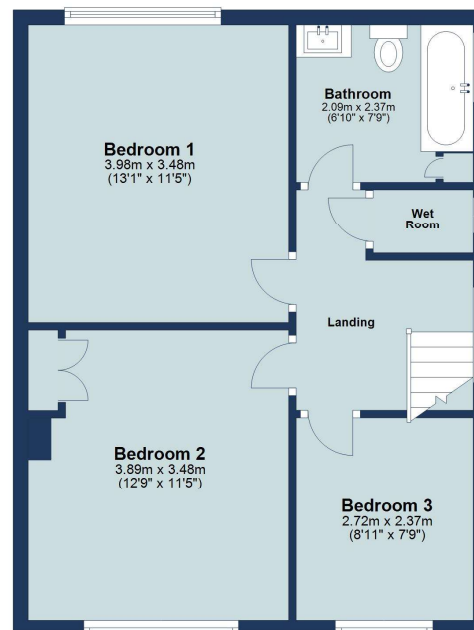

Total area: approx. 98.0 sq. metres (1054.5 sq. feet)

Floor plan is for marketing purposes only and is to be used as a guide.  
Garage not included in the total floor area.  
Plan produced using PlanUp.

IMPORTANT NOTICE: These particulars are for guidance only. Whilst every effort has been made to ensure the accuracy of the descriptions, plans, and measurements, these are not guaranteed, and they do not form part of any contract or tenancy. We have not tested any of the services, equipment, or fittings. No person in this firm's employment has the authority to make or give any representation or warranty in respect of the property. Interested parties should satisfy themselves as to the conditions of any such items considered material to their prospective purchase or tenancy and may wish to consult an independent advisor. It should not be assumed that any of the articles depicted in these particulars are included in the purchase or tenancy. You may download, store, and use the material for your personal use. You may not republish the material in any format without the consent of Bradford & Howley.

Looking to Sell or Let your current home?



Scan me to request your FREE Instant Online Valuation!

**Fresh**  
FINANCIAL



Sign up for FREE mortgage monitoring today, giving you peace of mind you are on the right deal, every month.

We will compare your mortgage against thousands of deals and send you a monthly report.

Please note that mortgage monitoring does not constitute mortgage advice.

**BRADFORD & HOWLEY**  
HARPENDEN | MARSHALSWICK | ST ALBANS

**f** @bradfordandhowley  
**ig** @bradfordandhowley  
**in** @bradford-howley  
**yt** @bradfordhowley4660

**tel** 01727 856999  
**envelope** marshalswick@bradfordandhowley.com  
**location** 5 The Quadrant, Marshalswick, St Albans, Herts, AL4 9RA

bradfordandhowley.com