

PENNY & SINCLAIR



3 Grants Mews, 65 Princes Street, Oxford, OX4 1DF

A modern mid terrace house situated in this very well located courtyard development within easy reach of the Cowley Road, London/airport coach stop and South Park.

Guide Price £425,000

DESCRIPTION

A modern mid terrace house situated in this very well located courtyard development within easy reach of the Cowley Road, London/airport coach stop and South Park. The accommodation is arranged over two floors and comprises, sitting room, kitchen/breakfast room, two bedrooms and bathroom. Outside there is a secluded courtyard garden and an allocated parking space. Offered with no onward chain.

LOCATION

Princes Street is located to the east of the city centre and within easy reach of Magdalen Bridge and the High Street. The location offers shops, bars, restaurants and the local cinema within a few minutes walk, as is the bus stop on St Clements Street with a regular service to London and airports. South Park is a short walk away.

DIRECTIONS

From The Plain, proceed along the Cowley Road. Turn left into Princes Street. Grants Mews will be found a short way along on the left hand side.

VIEWING ARRANGEMENTS

Strictly by appointment with Penny & Sinclair. Prior to making an appointment to view, Penny & Sinclair strongly recommend that you discuss any particular points which are likely to affect your interest in the property with a member of Penny & Sinclair's staff who has seen the property, in order that you do not make a wasted journey.

SERVICES

Mains water and electricity.

FIXTURES & FITTINGS

Certain items may be available by separate negotiation with Penny & Sinclair.

TENURE & POSSESSION

The property is freehold and offers vacant possession upon completion.

LOCAL AUTHORITY & COUNCIL TAX

Oxford City Council
City Chambers
Queen Street
Oxford
OX1 1EN
Telephone (01865) 249811
Council Tax Band C - £1,697.59 for 2018/19

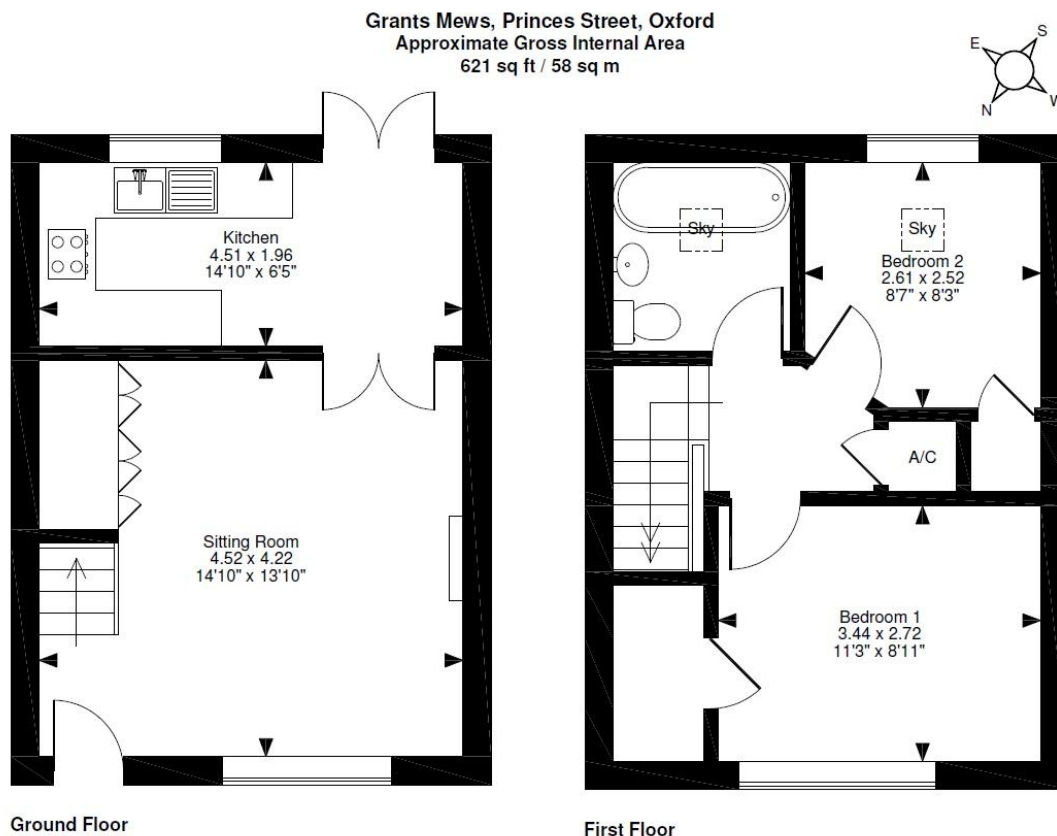

FOR ILLUSTRATIVE PURPOSES ONLY - NOT TO SCALE

The position & size of doors, windows, appliances and other features are approximate only.
© ehouse. Unauthorised reproduction prohibited. Drawing ref. dig/8234759/PHY