

IMPORTANT NOTICE Penny & Sinclair, their clients and any joint agent gives notice to anyone reading these particulars that: i) the particulars do not constitute part of an offer or contract; ii) all descriptions, dimensions, references to the condition and necessary permissions for use and occupation, and other details are given without responsibility and any intending purchasers should not rely on them as statement or representations of fact; iii) the text, photographs and plans are guidelines only and are not necessarily comprehensive. Any reference to alterations to, or use of, any part of the property does not mean that all necessary planning, building regulations or other consents have been obtained and Penny & Sinclair have not tested any services, equipment or facilities. A buyer or lessee must satisfy themselves by inspection or otherwise; iv) the descriptions provided therein represent the opinion of the author and whilst given in good faith should not be construed as statements of fact; v) nothing in the particulars shall be deemed a statement that the property is in good condition or otherwise, nor that any services or facilities are in good working order; vi) no person in the employment of Penny & Sinclair has any authority to make or give any representation or warranty whatsoever in relation to this property; vii) all measurements are approximate.

Whilst every attempt has been made to ensure the accuracy of the floor plan contained here, measurements of doors, windows, rooms and any other items are approximate and no responsibility is taken for any error, omission, or mis-statement. This plan is for illustrative purposes only and should be used as such by any prospective purchaser. The services, systems and appliances shown have not been tested and no guarantee as to their operability or efficiency can be given
Made with Metropix ©2018

GROUND FLOOR
APPROX. FLOOR
AREA 438 SQ. FT.
(40.7 SQ.M.)

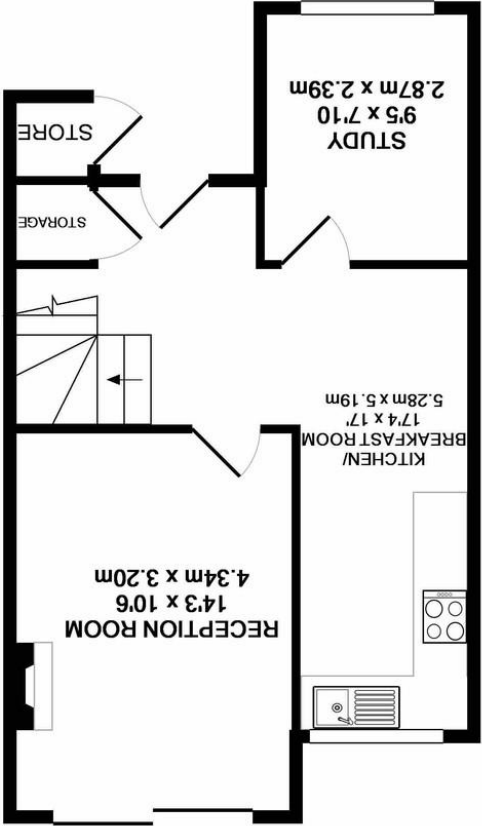

1ST FLOOR
APPROX. FLOOR
AREA 347 SQ. FT.
(32.3 SQ.M.)

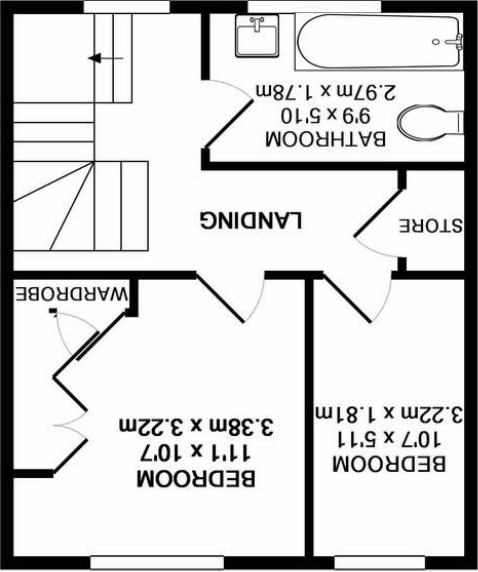

THE CLOSE

HENLEY-ON-THAMES, RG9

A beautifully presented two/three-bedroom house located within 0.5 miles of Henley town centre, station and River Thames. With versatile accommodation, a low maintenance landscaped garden and off-road parking. Furnished or Unfurnished. EPC Rating C. Available Now.

Two/ Three Bedroom House

Within 0.5 Miles of Henley Town Centre

Landscaped Garden and Off-Road Parking

Furnished or Unfurnished

EPC Rating C

Available Now

ACCOMMODATION

The front door opens into an airy entrance area with storage, which leads through to a spacious kitchen/breakfast room stocked with an excellent level of cupboards plus a range of appliances. The reception room offers generous and bright space with access out to the attractive rear garden. There is an additional third bedroom/ study which is neutrally decorated, providing versatile accommodation. Upstairs are two neutrally decorated double bedrooms, the master has useful built-in storage. The family bathroom has been fitted with a modern white suite which includes a bath with fixed shower attachment.



OUTSIDE SPACE

The rear garden is enclosed and has been skillfully landscaped with stone paving and a useful storage shed. A lockable rear gate provides rear access. To the front of the property is a further storage area and off-road parking for multiple cars.

LOCATION

Henley has a comprehensive range of shopping facilities, Waitrose supermarket, doctors' surgeries and a library. In addition there is a 3 screen cinema, the Kenton theatre, leisure facilities, several restaurants, cafes/public houses and several recreational facilities associated with the River Thames. Further amenities can be found in Oxford, Windsor, Marlow and Reading. The commuter is well provided for. Henley Station (2 minute walk) has a direct links with London Paddington via Twyford (47 mins). The M4/M40 J8/9/4 are 9 miles distant giving access to London, Heathrow, Midlands and West Country. Sporting facilities are in abundance including a choice of golf courses with racing at Newbury, Ascot and Windsor

