



Java House, London City Island, Botanic Square, Canning Town, E14

Asking price **£600,000** | Leasehold



Java House, London City Island, Botanic Square, Canning Town, E14

-  2 Bedrooms
-  2 Bathrooms
-  1 Reception
-  Balcony
-  Parking
-  Gymnasium
-  Local Amenities
-  24-Hour Concierge
-  0.4 MI East India

A spacious two bedroom, two bathroom apartment with parking, located on the 5th floor of Java House, part of the award winning London City Island development. This charming property benefits from a private balcony and river views.

Spread across, c.813 sq ft, the property benefits from two large double bedrooms, with the master having access to an ensuite bathroom. The open plan kitchen living room offers an abundance of styling with oak engineered floors and a height of smart design kitchen with bespoke shelves and cabinets.

All of the Islands residents are members of the exclusive City Island Social club, with membership comes access to a range of stylishly designed private facilities. These include, a clubhouse, concierge, a grocers shop, gymnasium, spa & treatment rooms, a screening room, pools and gardens. Travel options are bountiful with the DLR, Jubilee Line and local bus routes all within reach.

Tenure:	Leasehold (990 years remaining)	Local Authority:	Tower Hamlets
Ground Rent:	£750 p.a.	Council Tax Band:	E
Service Charge:	£6,300 p.a.	EPC:	B



Floorplan

813 sq ft | 75.5 sq m

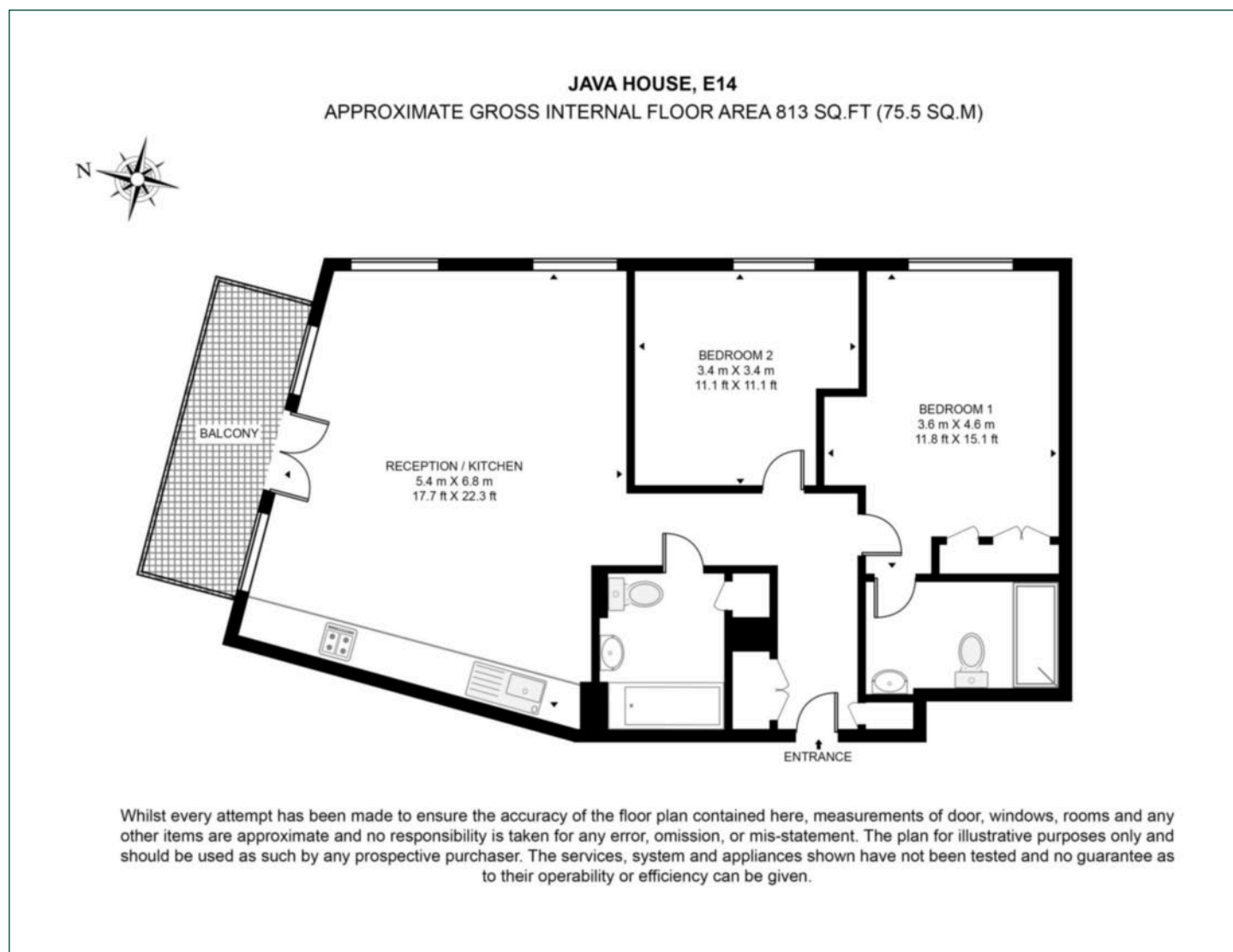

Docklands

St David's Square, 320 Westferry Road, London, E14 3QL

Sales

020 7510 8445 | docklands.sales@chaseevans.co.uk

We're here to help.

IMPORTANT NOTICE - These particulars have been prepared in good faith and they are not intended to constitute part of an offer or contract. We have not performed a structural survey on this property and the services, appliances and specific fittings have not been tested. All photographs, measurements, floor plans and distances referred to are given as a guide and should not be relied upon.

chaseevans.com

 Chase Evans