



Sky Gardens, Wandsworth Road, Nine Elms, SW8

Price **£800 per week** | Furnished



Sky Gardens, Wandsworth Road, Nine Elms, SW8

-  2 Bedrooms
-  2 Bathrooms
-  1 Reception
-  Winter Garden
-  Gymnasium
-  Local Amenities
-  24-Hour Concierge
-  0.1 MI Nine Elms

Bright two bedroom apartment with a private balcony set within the breath-taking Sky Gardens development in Nine Elms, SW8. The apartment features an modern integrated kitchen, a lounge with full length windows and wood flooring, private winter garden, ample master bedroom with fitted storage and en-suite, good-sized 2nd bedroom and family bathroom suite.

Sky Gardens offers impressive onsite amenities including a 24-hour concierge, a stylish gym and garden area, and the roof garden with 360-degree views of London. The development is a short walk

away from Vauxhall station and a stroll from the Thames and the new Nine Elms district with shops and riverside restaurants.



Local Authority:	Lambeth London
Council Tax Band:	F
EPC:	B
Security deposit:	equivalent to 5 weeks' rent

Floorplan

704 sq ft | 65.37 sq m

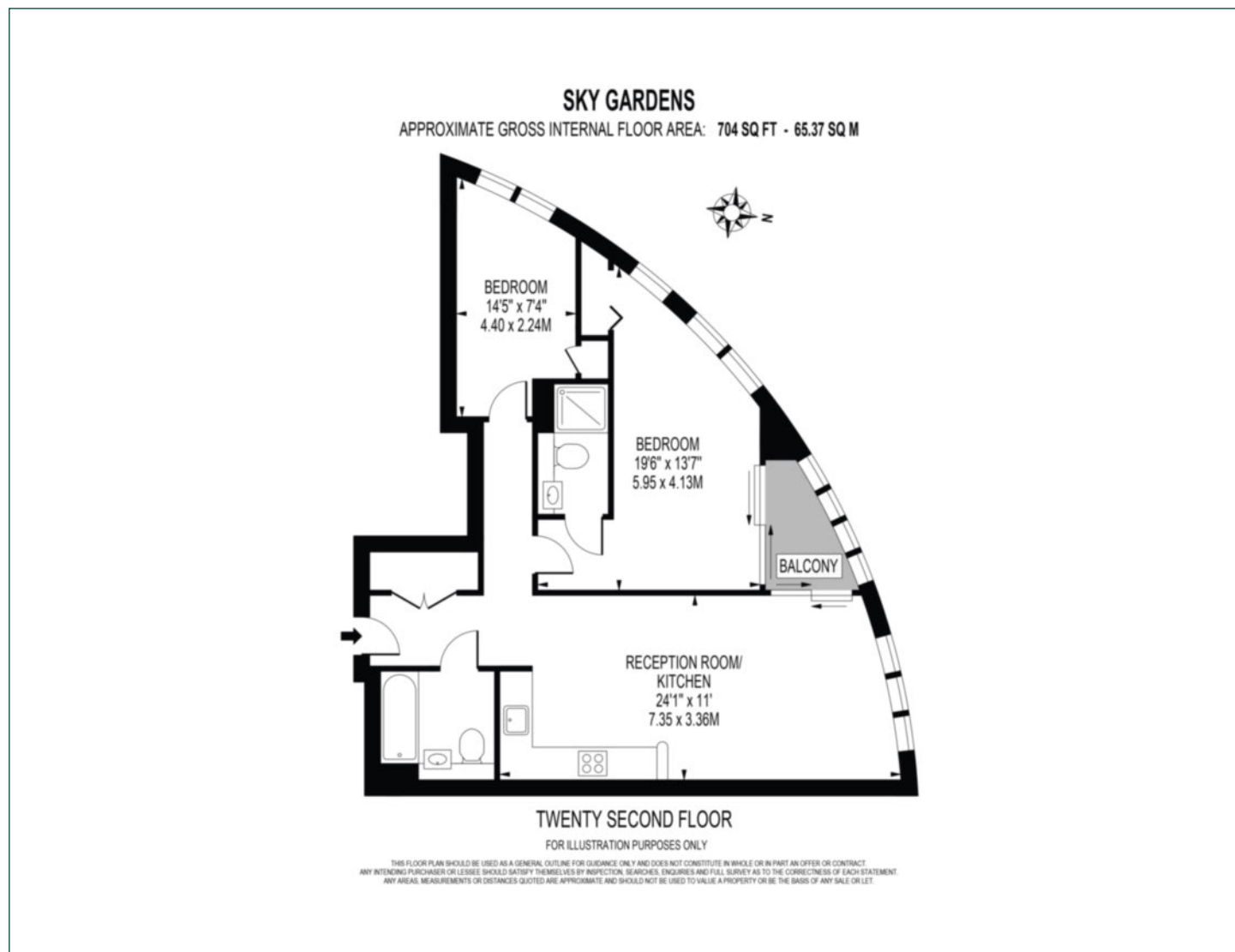

Elephant & Castle

One The Elephant, 5 St Gabriel Walk, London, SE1 6FA

Lettings

020 3869 2888 | eandc.lettings@chaseevans.co.uk

We're here to help.

IMPORTANT NOTICE - These particulars have been prepared in good faith and they are not intended to constitute part of an offer or contract. We have not performed a structural survey on this property and the services, appliances and specific fittings have not been tested. All photographs, measurements, floor plans and distances referred to are given as a guide and should not be relied upon.

chaseevans.com

 Chase Evans