



Stock House, Elephant Park, Wansey Street, Elephant & Castle, SE17

Price **£575 per week** | Furnished



Stock House, Elephant Park, Wansey Street, Elephant & Castle, SE17

-  1 Bedroom
-  1 Bathroom
-  1 Reception
-  Balcony
-  Gymnasium
-  Secure Cycle Storage
-  Local Amenities
-  24-Hour Concierge
-  0.1 MI Elephant & Castle

Bright and airy one bedroom apartment forming part of the impressive 'Elephant Park' development. This furnished apartment comprises a open plan living area with wood flooring, gloss fitted kitchen with appliances, large bedroom with built in storage and access to the balcony, bathroom with modern décor and a private terrace.

Residents benefit from an array of facilities which will include a gymnasium, communal gardens, secure cycle storage and a 24-hour concierge service. There are several amenities located nearby including bars, cafés, restaurants. The development

is located close to Elephant and Castle National Rail and Underground stations, providing Underground and Rail services for commutes towards the City and West End. The property is serviced by Thameslink, Southeastern, Bakerloo and Northern Line, opening a plethora of transport links.



Local Authority:	Southwark Council
Council Tax Band:	D
EPC:	B
Security deposit:	equivalent to 5 weeks' rent

Floorplan

542 sq ft | 50.4 sq m

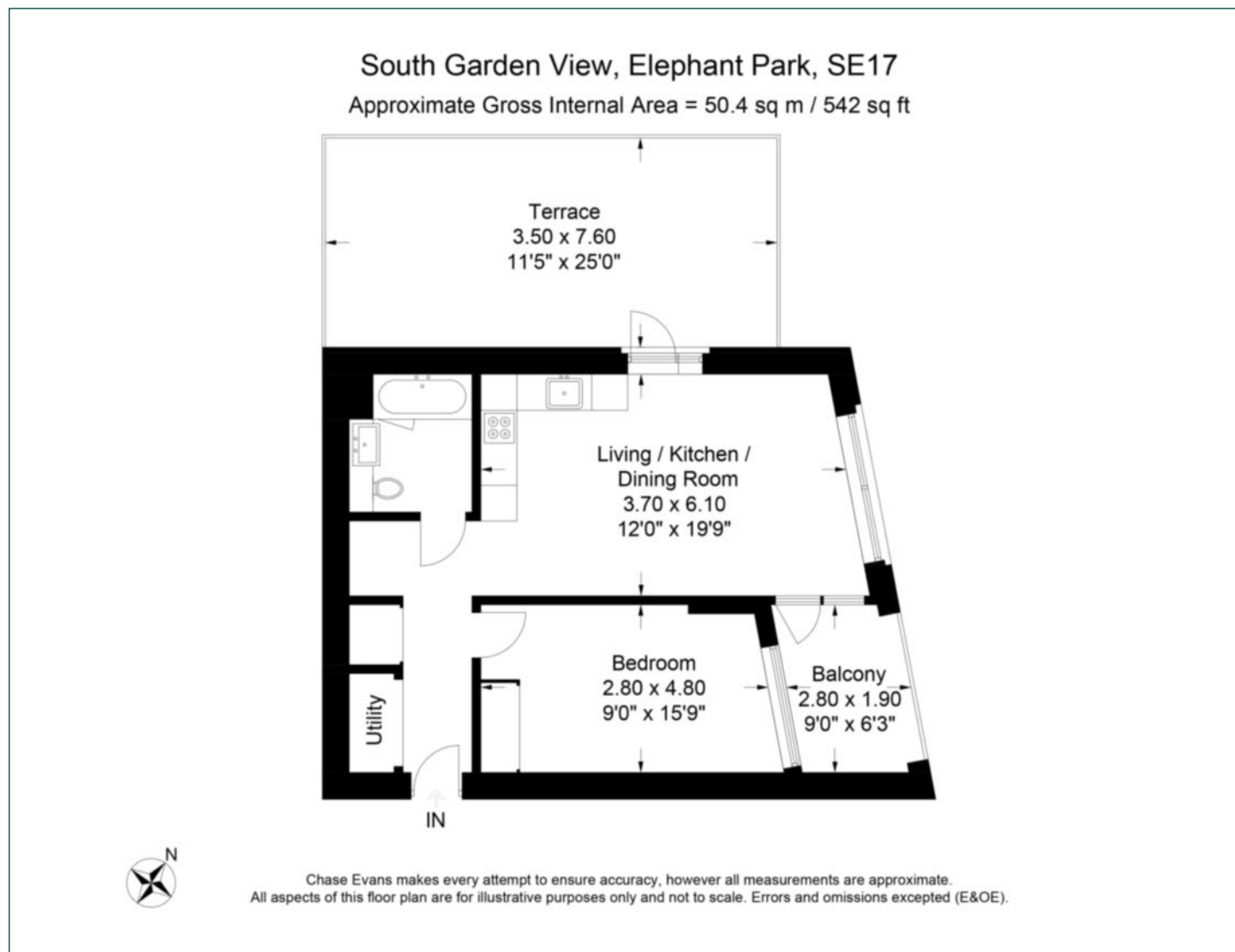

Elephant & Castle

One The Elephant, 5 St Gabriel Walk, London, SE1 6FA

Lettings

020 3869 2888 | eandc.lettings@chaseevans.com

We're here to help.

IMPORTANT NOTICE - These particulars have been prepared in good faith and they are not intended to constitute part of an offer or contract. We have not performed a structural survey on this property and the services, appliances and specific fittings have not been tested. All photographs, measurements, floor plans and distances referred to are given as a guide and should not be relied upon.

chaseevans.com

 Chase Evans