



## Wallace Court, Kidbrooke Village, Tizzard Grove, Kidbrooke, SE3

Price **£500 per week** | Furnished



# Wallace Court, Kidbrooke Village, Tizzard Grove, Kidbrooke, SE3

-  2 Bedrooms
-  2 Bathrooms
-  1 Reception
-  Terrace
-  Nearby Green Spaces
-  Local Amenities
-  24-Hour Concierge
-  0.2 MI Kidbrooke

Modern, spacious and flooded with light, two bedroom and two bathroom apartment with a private balcony in the impressive Kidbrooke Village development SE3. This furnished apartment includes an open plan kitchen/living area extending onto a generous balcony, two sizable double bedrooms with fitted storage and two modern bathrooms.

Kidbrooke Village is a new neighbourhood in the Royal Borough of Greenwich providing residents with access to a 24-hour concierge within the development, a good selection of shops,

restaurants and a variety of large public green spaces. This award winning development is located a short distance from Kidbrooke railway station, which is serviced by Southeastern rail lines providing fast trains to London Charing Cross, Cannon Street and the City.

Local Authority:	Greenwich London
Council Tax Band:	D
EPC:	B
Security deposit:	equivalent to 5 weeks' rent





# Floorplan

699 sq ft | 63.6 sq m

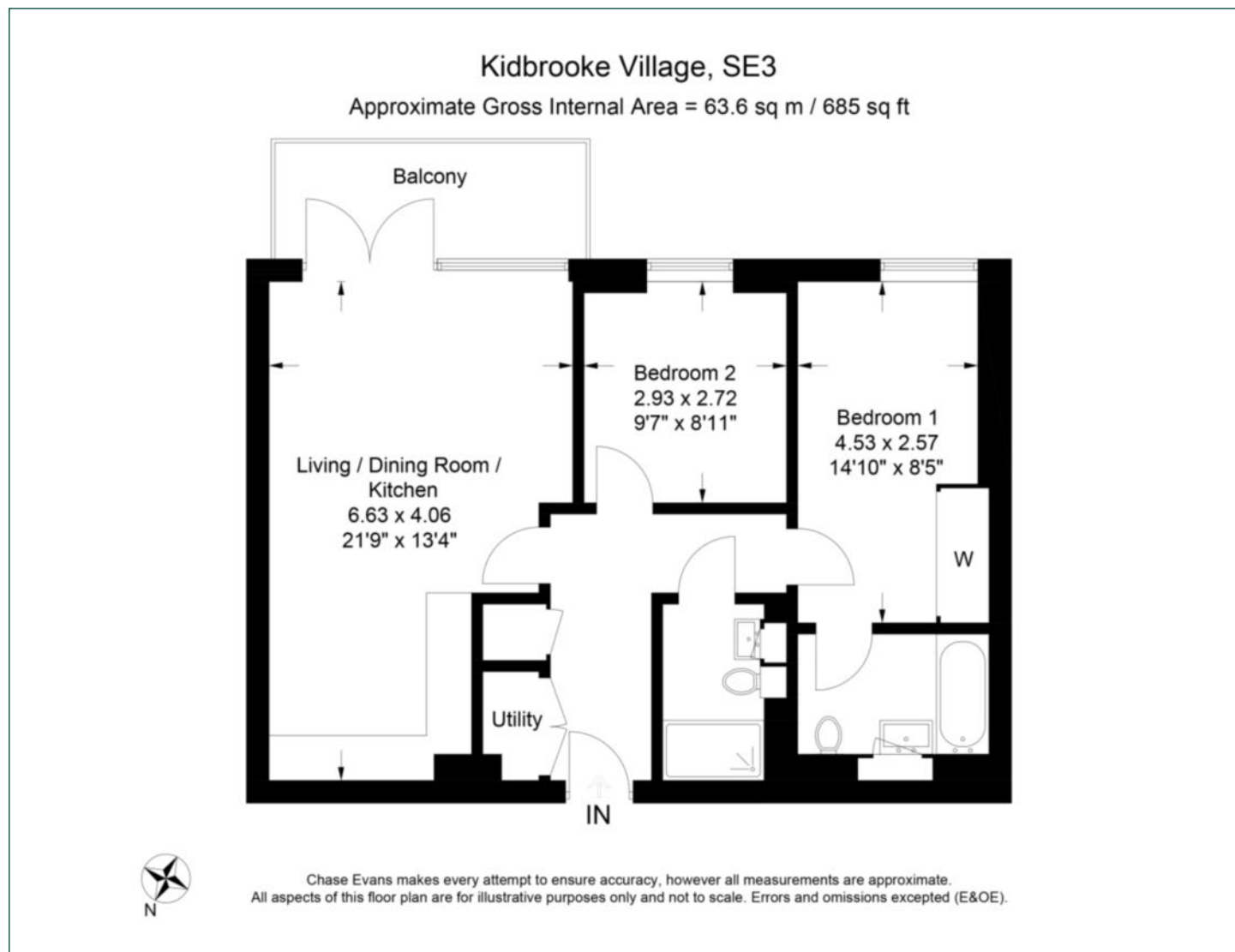

## Greenwich

1 Crescent Arcade, 279 Creek Road, London, SE10 9EJ

## Lettings

020 8853 8979 | [greenwich.lettings@chaseevans.com](mailto:greenwich.lettings@chaseevans.com)

**We're here to help.**

IMPORTANT NOTICE - These particulars have been prepared in good faith and they are not intended to constitute part of an offer or contract. We have not performed a structural survey on this property and the services, appliances and specific fittings have not been tested. All photographs, measurements, floor plans and distances referred to are given as a guide and should not be relied upon.

[chaseevans.com](https://chaseevans.com)

 Chase Evans