



St Davids Square, Isle of Dogs, E14

OIEO **£550,000** | Leasehold



St Davids Square, Isle of Dogs, E14

-  2 Bedrooms
-  2 Bathrooms
-  1 Reception
-  Underground Parking
-  Riverside Development
-  Gymnasium
-  Local Amenities
-  24-Hour Concierge
-  0.1 MI Island Gardens

A well presented two double bedroom, two bathroom property set in the ever popular St Davids Square riverside development. The property consists of a generous reception room, separate kitchen, floor to ceiling glazing, modern family bathroom and large store cupboard. Also featuring two double bedrooms including an en-suite to the master.

Residents have access to 24-hour concierge services and fitness facilities including a swimming pool, Jacuzzi, sauna and gymnasium. An excellent range of local amenities including a restaurant and

bars could be found at The Old Millwall Fire Station and further along Westferry Road.

The apartment is moments from Millwall Park and Island Gardens (5-min walk away). The nearest station is Island Gardens DLR. St David's Square is conveniently placed for Thames Clipper River bus services and for the Greenwich Foot Tunnel.

Tenure:	Leasehold (974 years remaining)	Local Authority:	Tower Hamlets
Ground Rent:	£350 p.a.	Council Tax Band:	D
Service Charge:	£4,900 p.a.	EPC:	C



Floorplan

877 sq ft | 81.47 sq m

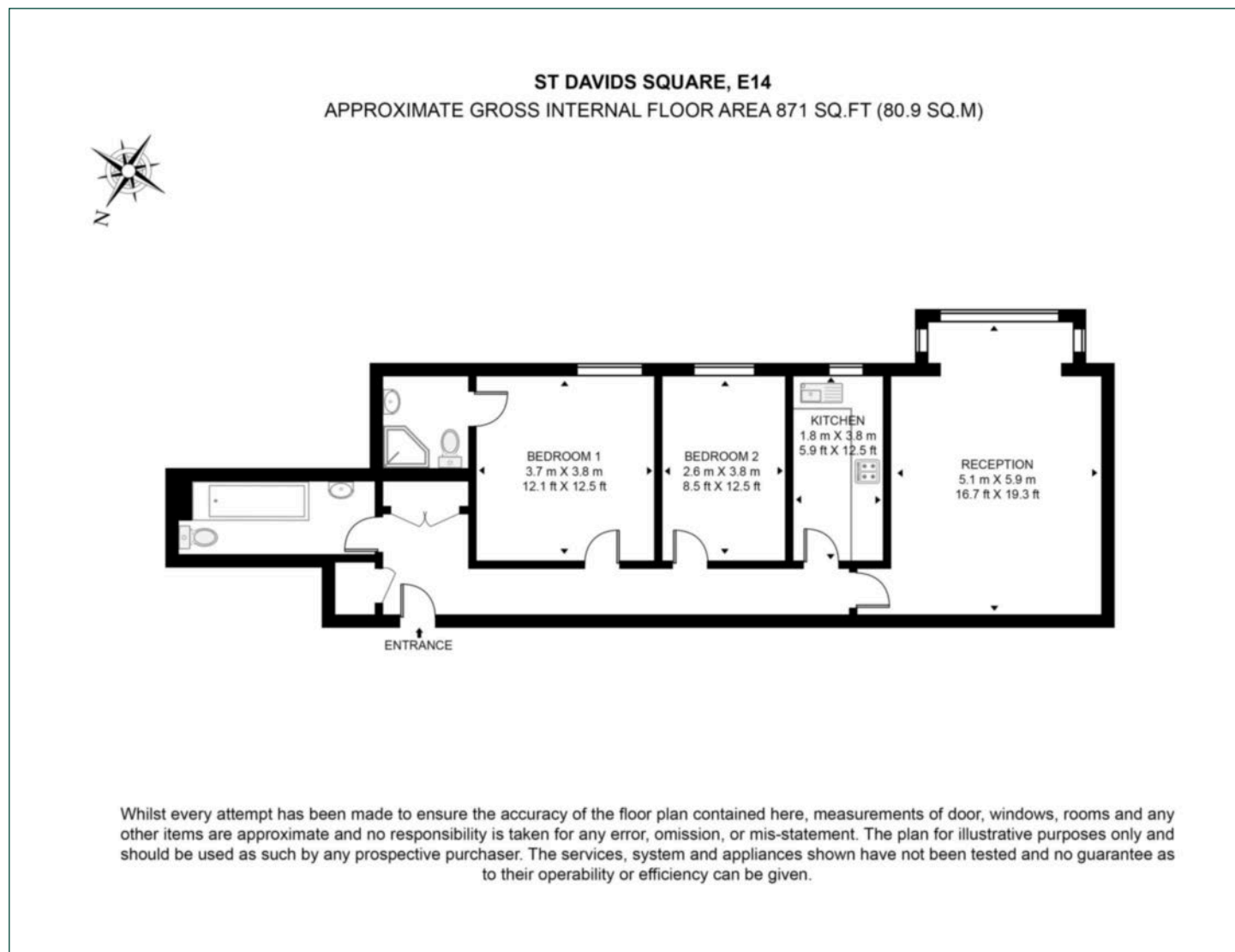

Docklands

St David's Square, 320 Westferry Road, London, E14 3QL

Sales

020 7510 8445 | docklands.sales@chaseevans.co.uk

We're here to help.

IMPORTANT NOTICE - These particulars have been prepared in good faith and they are not intended to constitute part of an offer or contract. We have not performed a structural survey on this property and the services, appliances and specific fittings have not been tested. All photographs, measurements, floor plans and distances referred to are given as a guide and should not be relied upon.

chaseevans.com

 Chase Evans