



Orion Point, Crews Street, Isle of Dogs E14

Price **£540 per week** | Furnished



Orion Point, Crews Street, Isle of Dogs E14

-  2 Bedrooms
-  2 Bathrooms
-  1 Reception
-  Balcony
-  Gymnasium
-  Local Amenities
-  24-Hour Concierge
-  0.5 MI Mudchute

A stunning two bedroom, two bathroom apartment on the 11th floor of this exclusive gated riverside development, E14.

This furnished property includes an inviting living and dining area, high-spec kitchen with integrated appliances, wood flooring, fitted bedroom storage, master en suite, stylish bathroom suite and a private balcony providing panoramic views across London.

Residents also have access to a 24-hour concierge service, on-site restaurant and a residents'

gymnasium. The development is located near to Mudchute DLR station, providing a valuable transport link for commutes to Canary Wharf and the City.



Local Authority:	Tower Hamlets
Council Tax Band:	F
EPC:	B
Security deposit:	equivalent to 5 weeks' rent

Floorplan

828 sq ft | 76 sq m

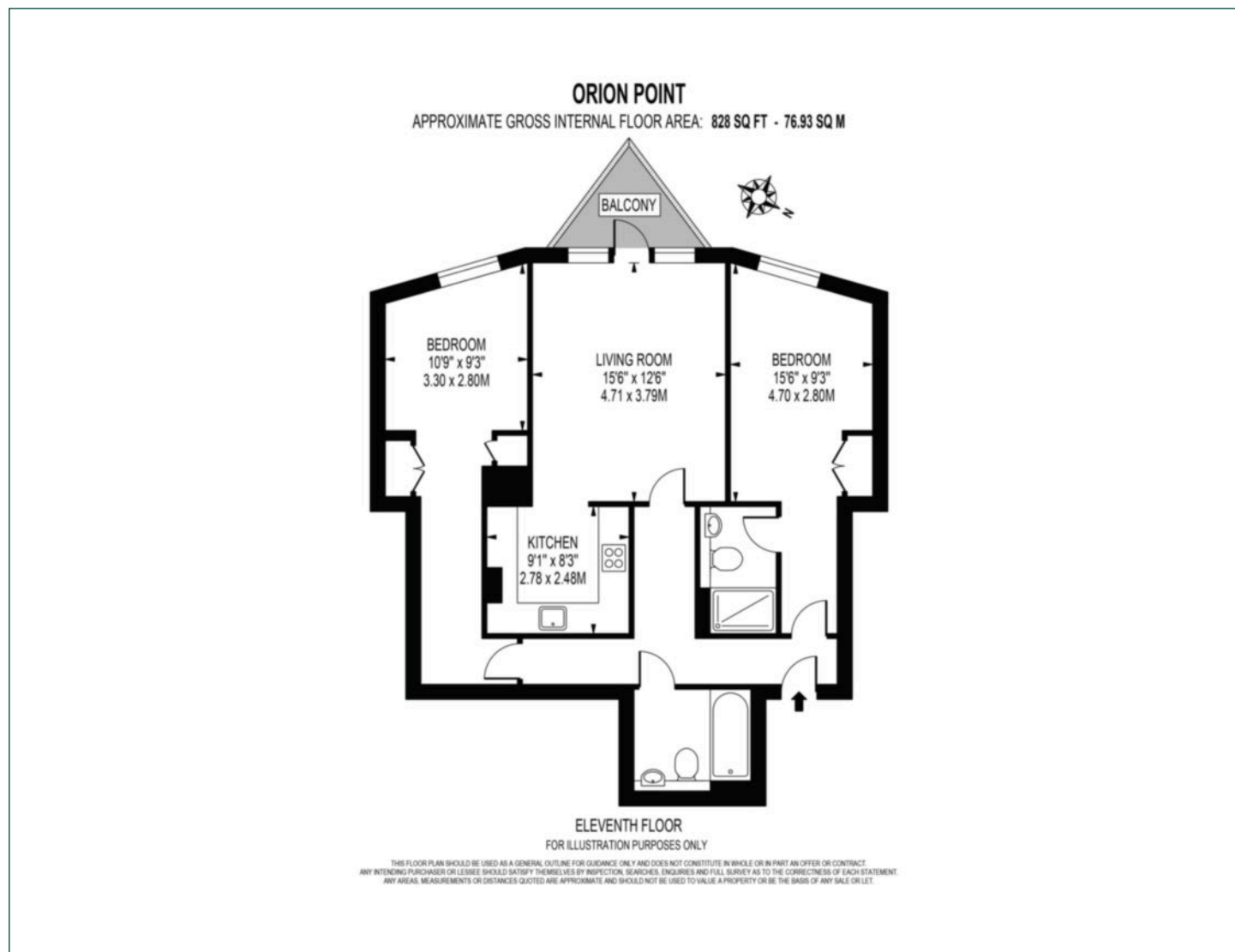

Docklands

St David's Square, 320 Westferry Road, London, E14 3QL

Lettings

020 7510 8444 | docklands.lettings@chaseevans.co.uk

We're here to help.

IMPORTANT NOTICE - These particulars have been prepared in good faith and they are not intended to constitute part of an offer or contract. We have not performed a structural survey on this property and the services, appliances and specific fittings have not been tested. All photographs, measurements, floor plans and distances referred to are given as a guide and should not be relied upon.

chaseevans.com