







## Carrara Tower, 250 City Road, Bollinder Place, Islington, EC1V

Price **£850 per week** | Furnished



# Carrara Tower, 250 City Road, Bollinder Place, Islington, EC1V

-  1 Bedroom
-  1 Bathroom
-  1 Reception
-  Winter Garden
-  Gymnasium
-  Local Amenities
-  24-Hour Concierge

\*PHOTOS FOR ILLUSTRATIVE PURPOSES ONLY\*

Stunning one bedroom apartment set within, 250 City Road EC1V. Comprising an open plan living area with a modern kitchen suite and integrated appliances, plus full height windows leading to a large private winter garden. Sizable master bedroom with fitted wardrobes and pristine bathroom suite.

Located in the heart of Zone 1 and within easy reach of Old Street, the City and Shoreditch, 250 City Road is an incredible development with the apartments

finished to a superb specification alongside five star facilities and landscaped gardens. Further benefits include a state-of-the-art gym, 20 metre swimming pool and spa, residents lounge and rooftop fitness terrace with views towards the City and canal basin. 24 hour concierge service is on-hand to provide assistance.



Local Authority:	Hackney London
Council Tax Band:	E
EPC:	B
Security deposit:	equivalent to 5 weeks' rent

# Floorplan

671 sq ft | 62.4 sq m

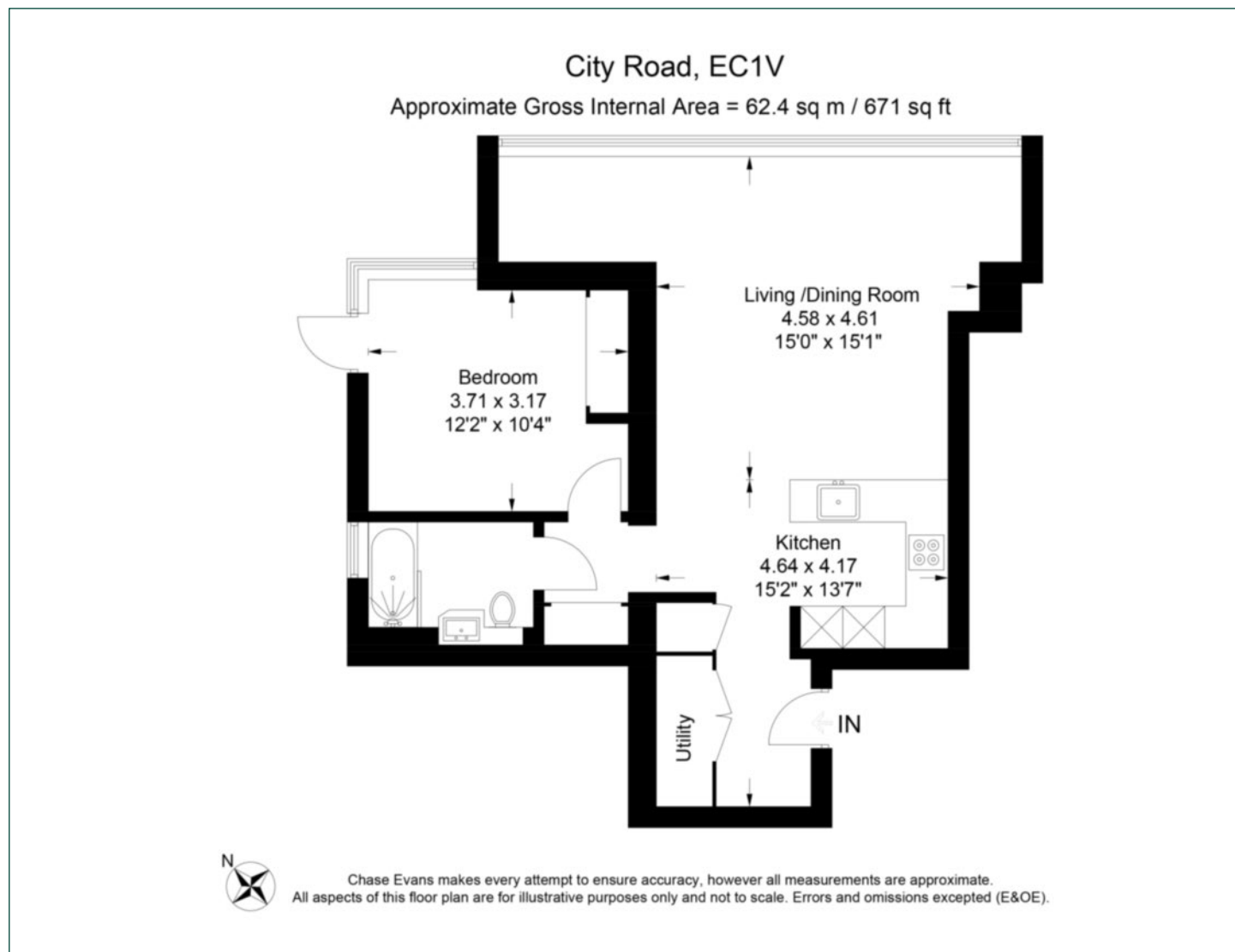

## City & Aldgate

122 Whitechapel High Street, London, E1 7PT

## Lettings

020 7247 3888 | [city.lettings@chaseevans.com](mailto:city.lettings@chaseevans.com)

## We're here to help.

IMPORTANT NOTICE - These particulars have been prepared in good faith and they are not intended to constitute part of an offer or contract. We have not performed a structural survey on this property and the services, appliances and specific fittings have not been tested. All photographs, measurements, floor plans and distances referred to are given as a guide and should not be relied upon.

[chaseevans.com](https://chaseevans.com)

 Chase Evans