









10 Park Drive, Wood Wharf, Canary Wharf, E14

Price **£665 per week** | Furnished



10 Park Drive, Wood Wharf, Canary Wharf, E14

-  1 Bedroom
-  1 Bathroom
-  1 Reception
-  24-Hour Concierge
-  Residents' Cinema & Lounge
-  Roof Garden
-  Local Amenities of Canary Wharf
-  0.2 MI Canary Wharf
-  0.5 MI Canary Wharf Elizabeth

This wonderfully bright one-bedroom apartment with partial dock views is set in 10 Park Drive, Wood Wharf, a waterside development in the heart of Canary Wharf E14. The open-plan living room/kitchen features engineered timber floors, underfloor heating, comfort cooling, a porcelain breakfast bar and full-length wall glazing. The ample-sized bedroom has a built-in wardrobe and there is a modern shower room, featuring smart fittings and porcelain tiling.

10 Park Drive offers 24-hour concierge services, access to a cinema, and the 13th-floor Sky Garden.

Local Authority:	Tower Hamlets
Council Tax Band:	E
EPC:	B
Security deposit:	equivalent to 5 weeks' rent



Floorplan

440 sq ft

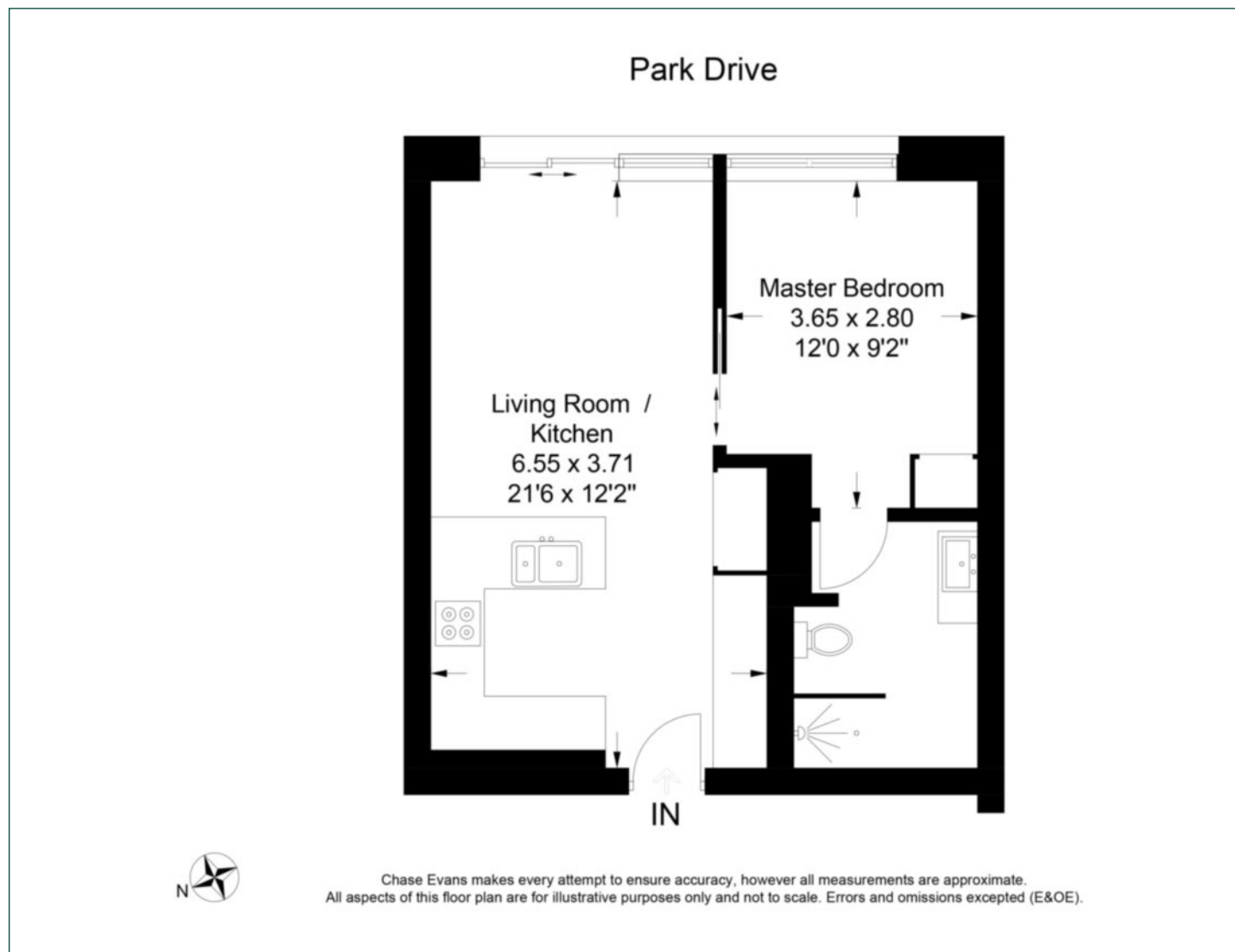

Pan Peninsula

Pan Peninsula, 1 Millharbour, London, E14 9XP

Lettings

020 7536 7900 | panp.lettings@chaseevans.com

We're here to help.

IMPORTANT NOTICE - These particulars have been prepared in good faith and they are not intended to constitute part of an offer or contract. We have not performed a structural survey on this property and the services, appliances and specific fittings have not been tested. All photographs, measurements, floor plans and distances referred to are given as a guide and should not be relied upon.

chaseevans.com

 Chase Evans