

Luna House, Tempus Wharf, Bermondsey Wall West SE16

Price **£699 per week** | Furnished



Luna House, Tempus Wharf, Bermondsey Wall West SE16

-  2 Bedrooms
-  2 Bathrooms
-  1 Reception
-  Balcony
-  River Views
-  Local Amenities
-  Daytime Concierge
-  0.2 MI Bermondsey

A two bedroom, two bathroom apartment set within Luna House; within the Tempus Wharf riverside development close to London Bridge. This furnished apartment includes an open plan living and dining area, fitted kitchen with integrated Siemens appliances, wood flooring, air conditioning, floor-to-ceiling windows, fitted bedroom storage, master en suite, tiled bathroom décor and private balcony.

Residents will also have access to a daytime concierge service and allocated parking. There are several amenities located nearby including

restaurants, shops and cafés. Butlers Wharf Pier is within walking distance and offers a great selection places along the riverside to enjoy a meal or cup of coffee. The development is located near to Bermondsey Underground station, providing a valuable transport link for commutes to key destinations across the Capital.



Local Authority:	Southwark Council
Council Tax Band:	E
EPC:	C
Security deposit:	equivalent to 5 weeks' rent

Floorplan

905 sq ft | 84.07 sq m

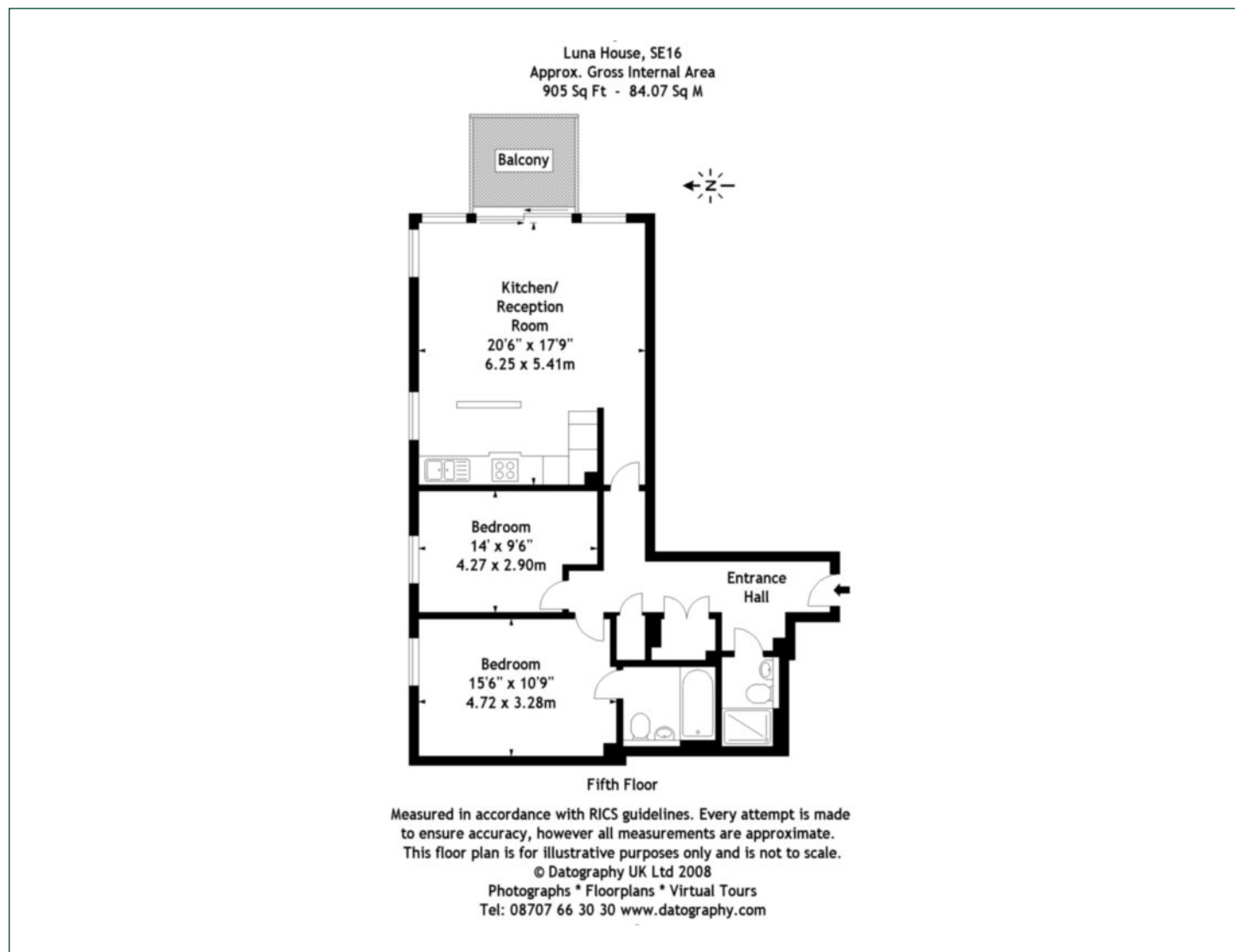

Elephant & Castle

One The Elephant, 5 St Gabriel Walk, London, SE1 6FG

Lettings

020 3869 2888 | eandc.lettings@chaseevans.com

We're here to help.

IMPORTANT NOTICE - These particulars have been prepared in good faith and they are not intended to constitute part of an offer or contract. We have not performed a structural survey on this property and the services, appliances and specific fittings have not been tested. All photographs, measurements, floor plans and distances referred to are given as a guide and should not be relied upon.

chaseevans.com

 Chase Evans