



West Tower, Pan Peninsula Square, Canary Wharf, E14

Price **£725 per week** | Furnished



West Tower, Pan Peninsula Square, Canary Wharf, E14

-  2 Bedrooms
-  2 Bathrooms
-  1 Reception
-  Balcony
-  Gymnasium
-  Local Amenities
-  24-Hour Concierge
-  0.1 MI South Quay

PHOTOS FOR ILLUSTRATIVE PURPOSES ONLY

A two bed, two bath apartment set within Pan Peninsula's West Tower. This furnished apartment includes a spacious dual-aspect living, dining area, separate fitted kitchen with integrated appliances, floor-to-ceiling windows, comfort cooling, fitted bedroom storage, master en suite and a private balcony offering south-easterly views towards Greenwich and O2 Arena.

Residents will also have access to a 24-hour concierge, an onsite private cinema, residents'

gymnasium and swimming pool. The development is within walking distance of Canary Wharf, providing access to transport links and a great selection of amenities including the Canary Wharf Shopping Centre.

Situated just a 2-mins walk from South Quay DLR station which makes commutes to areas such as Bank achievable in just 14-mins. The development is also within walking distance of Canary Wharf Underground and the Elizabeth Line service for high-speed connection pan throughout the Capital.



Local Authority:	Tower Hamlets
Council Tax Band:	G
EPC:	B
Security deposit:	equivalent to 5 weeks' rent

Floorplan

795 sq ft | 73.9 sq m

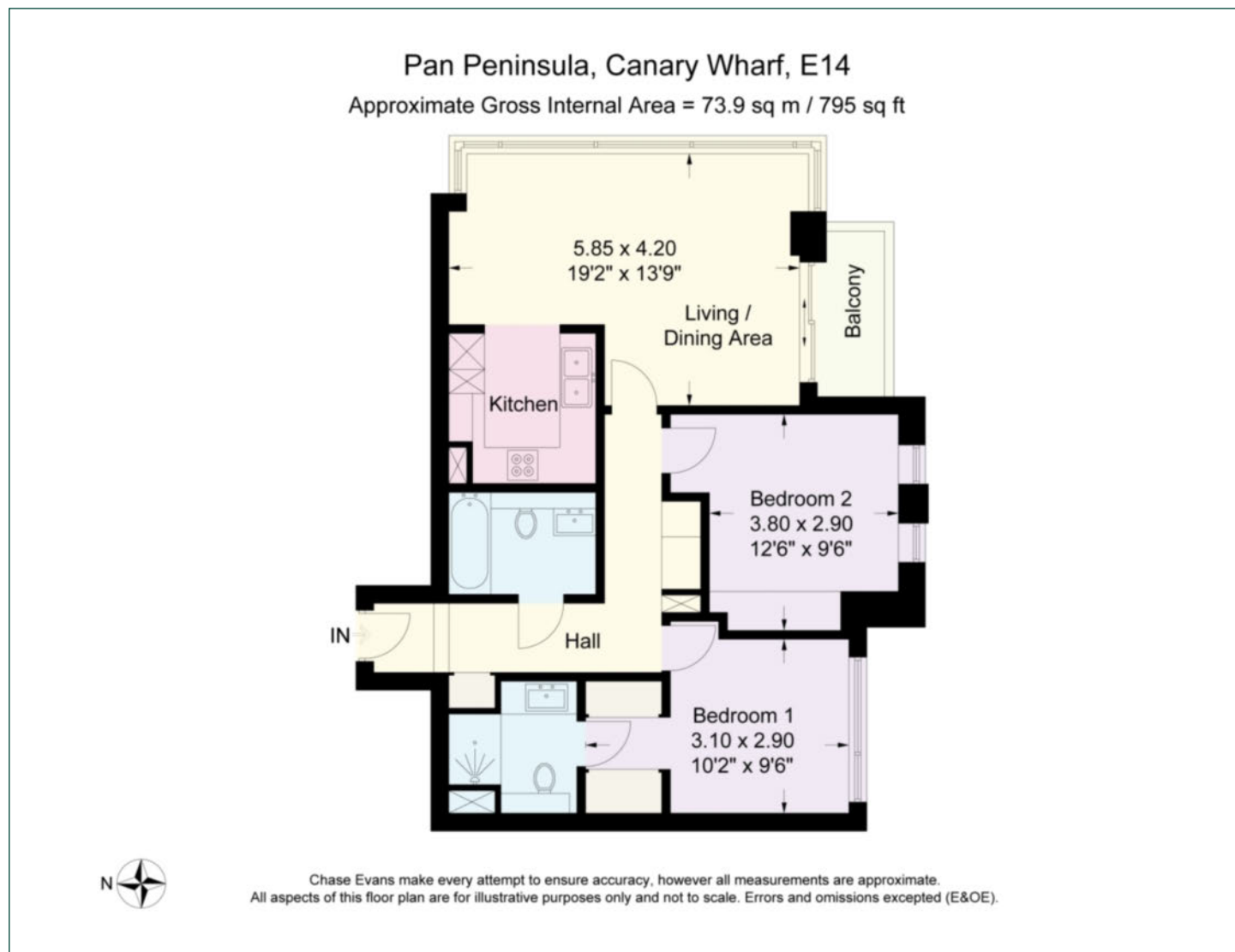

Pan Peninsula

Pan Peninsula, 1 Millharbour, London, E14 9XP

Lettings

020 7536 7900 | panp.lettings@chaseevans.com

We're here to help.

IMPORTANT NOTICE - These particulars have been prepared in good faith and they are not intended to constitute part of an offer or contract. We have not performed a structural survey on this property and the services, appliances and specific fittings have not been tested. All photographs, measurements, floor plans and distances referred to are given as a guide and should not be relied upon.

chaseevans.com

 Chase Evans