

## Pienna Apartments, Elvin Gardens, Wembley, HA9

Asking price **£375,000** | Leasehold



# Pienna Apartments, Elvin Gardens, Wembley, HA9

-  1 Bedroom
-  1 Bathroom
-  1 Reception
-  Balcony
-  24-Hour Concierge
-  Gymnasium
-  Bicycle Storage
-  Local Amenities
-  0.4 MI Wembley Park Station

Stunning one bedroom apartment with a balcony on the eighth floor of Pienna Apartments in Wembley Park, HA9. The property has a spacious living area with sliding glass doors leading out to a balcony with amazing views over the heart of Wembley, a stylish fitted & integrated kitchen suite, wooden flooring, recessed lighting throughout, a large double bedroom with fitted wardrobes and a stylish modern bathroom.

There are also numerous on-site amenities and services available to residents which include 24-hour concierge services, secure bicycle storage and a well-equipped residents' gymnasium.

Located in the Wembley Park area of regeneration, the property is close to the SSE Wembley Arena and Wembley Stadium. Residents will appreciate being within walking distance of several amenities along Wembley Park Drive that include several independent bars, restaurants, cafés and Wembley Park's London Designer Outlet provides an outstanding selection of leisure facilities and numerous shopping outlets.

The development is located a short distance from Wembley Park Underground station (9mins walk) providing a versatile transport link for commutes to Moorgate, Waterloo and other key destinations located across the Capital.

Tenure:	Leasehold (circa 291 years remaining)	Local Authority:	Brent London
Ground Rent:	£455.23 p.a.	Council Tax Band:	C
Service Charge:	£3,012.84 p.a.	EPC:	B

# Floorplan

534 sq ft | 49.6 sq m

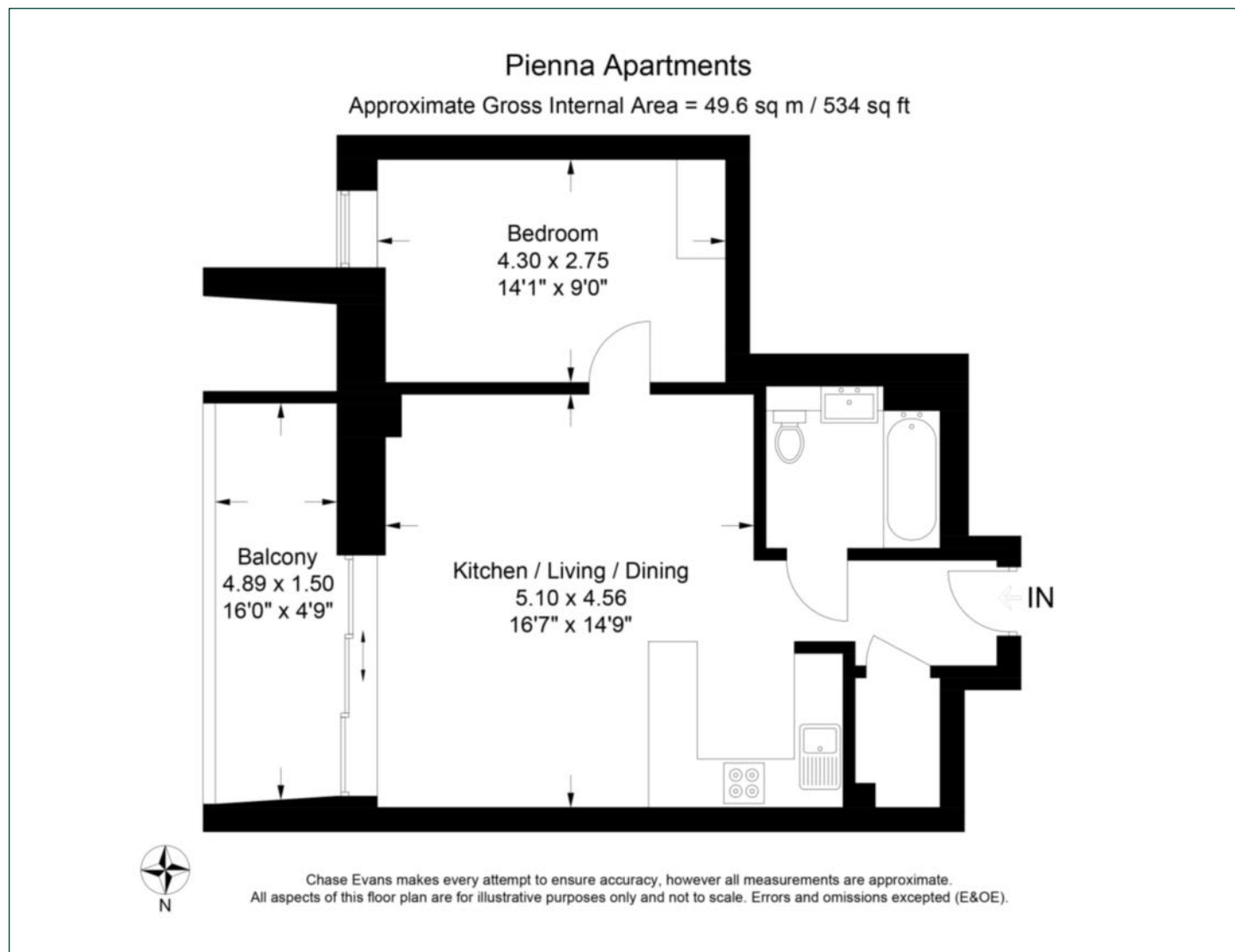

## City & Aldgate

122 Whitechapel High Street, London, E1 7PT

## Sales

020 7488 2777 | [city.sales@chaseevans.com](mailto:city.sales@chaseevans.com)

**We're here to help.**

IMPORTANT NOTICE - These particulars have been prepared in good faith and they are not intended to constitute part of an offer or contract. We have not performed a structural survey on this property and the services, appliances and specific fittings have not been tested. All photographs, measurements, floor plans and distances referred to are given as a guide and should not be relied upon.

[chaseevans.com](https://chaseevans.com)

 **Chase Evans**