











Hurlock Heights, Elephant Park, Deacon Street, Elephant & Castle, SE17

Price **£795 per week** | Furnished



Hurlock Heights, Elephant Park, Deacon Street, Elephant & Castle, SE17

-  2 Bedrooms
-  2 Bathrooms
-  1 Reception
-  Balcony
-  Secure Cycle Storage
-  Local Amenities
-  24-Hour Concierge
-  0.2 MI Elephant & Castle

Stunning, two bedrooms, two bathrooms apartment with a balcony in the popular Elephant Park development in SE17. Spacious and light, the open plan kitchen/ living area extends on to a private balcony with impressive area views and features large glazing, wood flooring, underfloor heating and comfort cooling. This streamlined kitchen is fully integrated with sleek gloss panelling and modern, fully integrated appliances. The master bedroom has an ensuite shower room and features a walk-in wardrobe and there is a further double bedroom and a full-size family bathroom.

Residents benefit from 24-hour concierge services, access to residents' lounge, communal gardens and a

roof terrace. A new, beautifully landscaped and maintained 0.4 hectares of green space nearby features mature trees, play trails and a lively performance area. It offers an oasis in the middle of Elephant & Castle, an ideal place to relax and enjoy expertly curated open-air events.

The apartment is located a short distance from the centre of Elephant and Castle which has an excellent variety of high street shops and restaurants. London College of Communication is also nearby, a 10-minute walk away. The development is close to Elephant and Castle National Rail and Underground stations, providing the Thameslink, Southeastern, Bakerloo and Northern Line services.

Local Authority:	Southwark Council
Council Tax Band:	E
EPC:	B
Security deposit:	equivalent to 5 weeks' rent



Floorplan

862 sq ft | 80.1 sq m

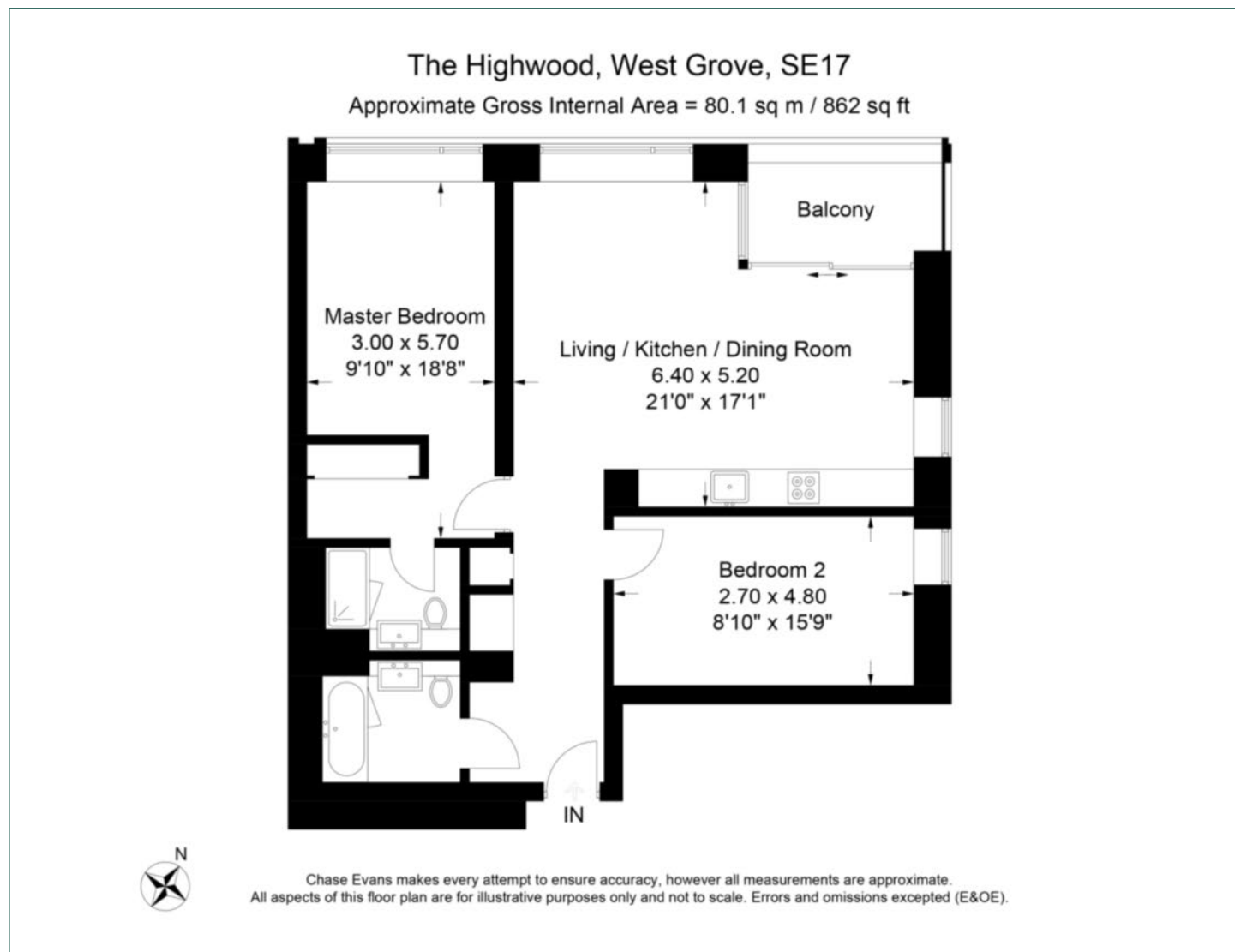

Elephant & Castle

One The Elephant, 5 St Gabriel Walk, London, SE1 6FA

Lettings

020 3869 2888 | eandc.lettings@chaseevans.co.uk

We're here to help.

IMPORTANT NOTICE - These particulars have been prepared in good faith and they are not intended to constitute part of an offer or contract. We have not performed a structural survey on this property and the services, appliances and specific fittings have not been tested. All photographs, measurements, floor plans and distances referred to are given as a guide and should not be relied upon.

chaseevans.com

 Chase Evans