









## Crawford Building, Whitechapel High Street, Aldgate, E1

Price **£575 per week** | Furnished



# Crawford Building, Whitechapel High Street, Aldgate, E1

-  1 Bedroom
-  1 Bathroom
-  1 Reception
-  Lift Access
-  Local Amenities
-  24-Hour Concierge
-  0.2 MI Aldgate

A stunning one bedroom apartment situated within Crawford Building enviably located directly above Aldgate East tube station, Aldgate E1. This modern apartment includes an open plan living area, fitted kitchen with integrated appliances, wood flooring, full length windows with stunning city skyline views, fitted bedroom storage, modern bathroom suite and a private balcony.

Residents will also have access to on-site lifts, door entry system, and a 24-hour concierge service. Ideally located on the edge of the City of London, just a stone's throw from Brick Lane Shoreditch and

Spitalfields market, ensuring excellent shopping amenities, bars, and restaurants.

Amazing transport links with tube stations on your doorstep, right above Aldgate East station (20ft) and 0.2 miles from Aldgate station, as well as an array of bus services that provides 24-hour routes into the City and West End.



Local Authority:	Tower Hamlets
Council Tax Band:	E
EPC:	B
Security deposit:	equivalent to 5 weeks' rent

# Floorplan

424 sq ft | 39.4 sq m

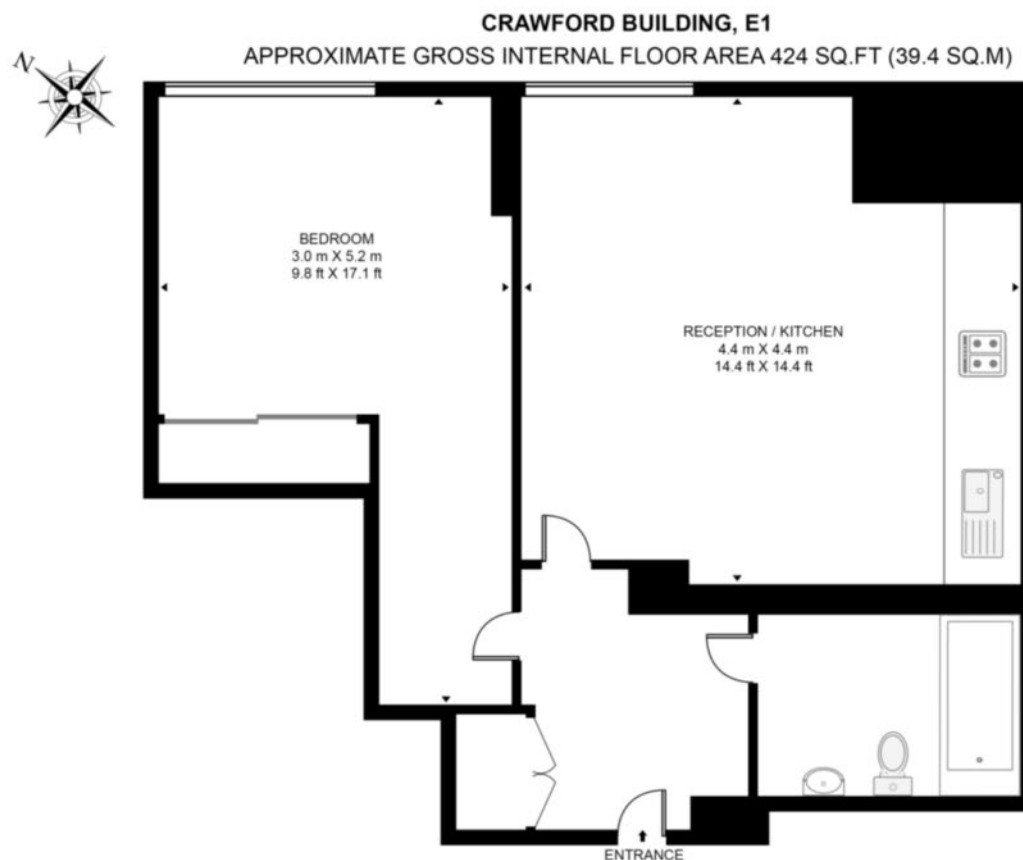

Whilst every attempt has been made to ensure the accuracy of the floor plan contained here, measurements of door, windows, rooms and any other items are approximate and no responsibility is taken for any error, omission, or mis-statement. The plan for illustrative purposes only and should be used as such by any prospective purchaser. The services, system and appliances shown have not been tested and no guarantee as to their operability or efficiency can be given.

## City & Aldgate

122 Whitechapel High Street, London, E1 7PT

## Lettings

020 7247 3888 | [city.lettings@chaseevans.com](mailto:city.lettings@chaseevans.com)

**We're here to help.**

IMPORTANT NOTICE - These particulars have been prepared in good faith and they are not intended to constitute part of an offer or contract. We have not performed a structural survey on this property and the services, appliances and specific fittings have not been tested. All photographs, measurements, floor plans and distances referred to are given as a guide and should not be relied upon.

[chaseevans.com](https://chaseevans.com)

 Chase Evans