



Corsair House, Starboard Way, Docklands, E16

Asking price **£390,000** | Leasehold



Corsair House, Starboard Way, Docklands, E16

-  1 Bedroom
-  1 Bathroom
-  1 Reception
-  Balcony
-  Gymnasium
-  Local Amenities
-  24-Hour Concierge
-  0.1 MI Pontoon Dock

Corsair House forms part of the highly coveted 'Royal Wharf' development. A modern luxury one bedroom apartment set in Corsair House within this sought-after riverside Royal Wharf development in E16. This dual-aspect apartment offers c. 619 sq. ft. of internal space featuring engineered oak flooring throughout, one bedroom, one contemporary bathroom with a sleek monochrome finish and large private terrace.

Offering an exceptional selection of ultra-modern restaurants, bars, cafés, delis and state-of-the art leisure facilities including a 20,000 square foot gym

and health suite with 25ft lap pool – Royal Wharf represents contemporary 21st century city living at its peak! The green open spaces of Thames Barrier Park also lie adjacent with views over the river and the Thames Barrier itself.

For the convenience of commuters, Pontoon Dock DLR Station (Canary Wharf only 8 mins approx) is located just moments away and the pier for the Thames Clipper is also virtually on the doorstep.

Tenure:	Leasehold (989 years remaining)	Local Authority:	Newham London
Ground Rent:	£480 p.a.	Council Tax Band:	D
Service Charge:	£3,100 p.a.	EPC:	B



Floorplan

619 sq ft | 57 sq m

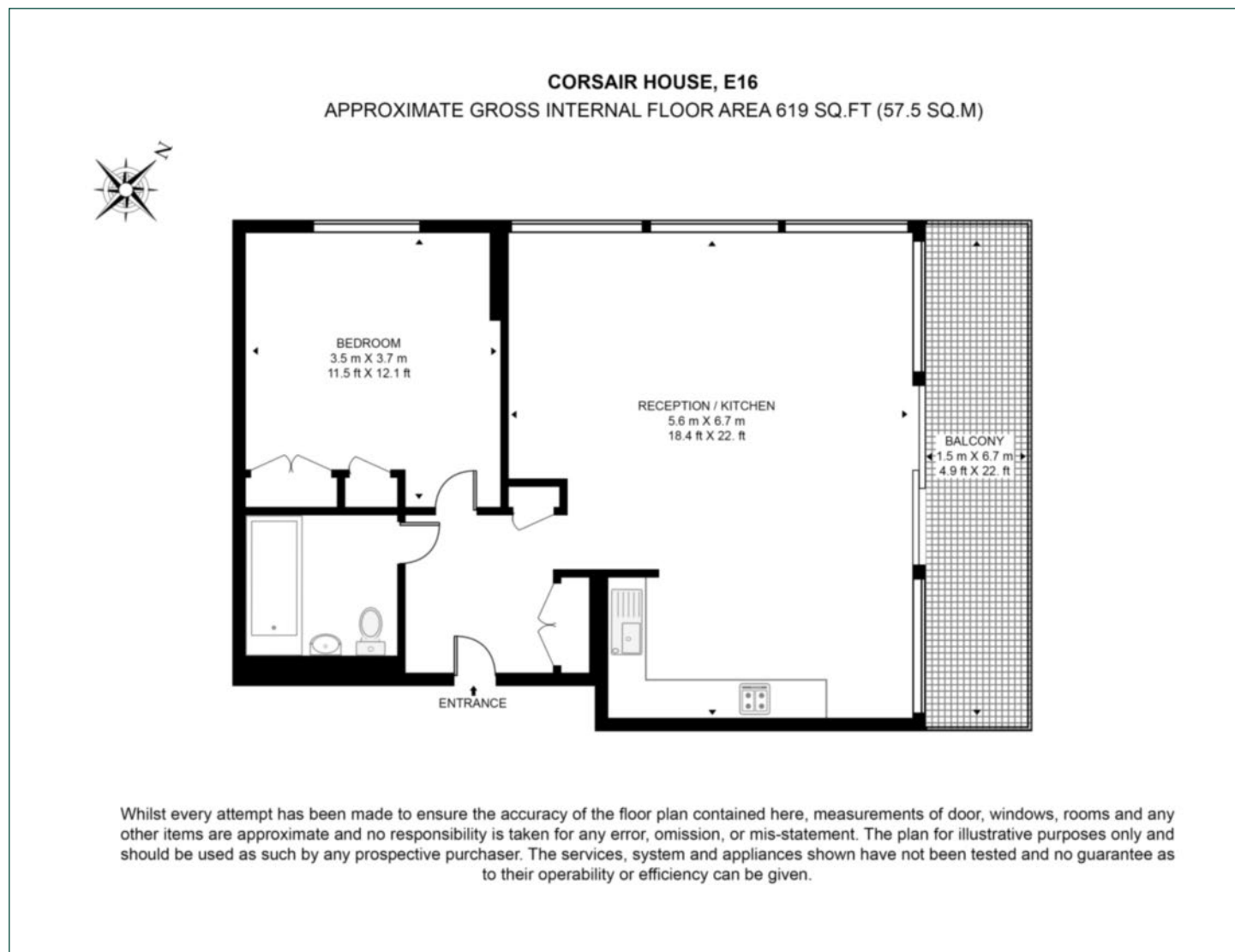

Docklands

St David's Square, 320 Westferry Road, London, E14 3QL

Sales

020 7510 8445 | docklands.sales@chaseevans.co.uk

We're here to help.

IMPORTANT NOTICE - These particulars have been prepared in good faith and they are not intended to constitute part of an offer or contract. We have not performed a structural survey on this property and the services, appliances and specific fittings have not been tested. All photographs, measurements, floor plans and distances referred to are given as a guide and should not be relied upon.

chaseevans.com