



Falcon Way, Clippers Quay, Isle of Dogs, E14

Asking price **£525,000** | Leasehold



Falcon Way, Clippers Quay, Isle of Dogs, E14

-  2 Bedrooms
-  1 Bathroom
-  1 Reception
-  Balcony
-  Dockside Developments
-  Parking
-  Nearby Green Spaces
-  0.1 MI Mudchute

A lovely top floor, two bedroom apartment with a balcony and parking set in the popular Clippers Quay development, Isle of Dogs E14.

Features include direct dock views, a private balcony, wood flooring, recessed spot lighting, a well equipped open plan kitchen, a master bedroom with built-in wardrobes, a second bedroom with dock views and a contemporary bathroom with smart fittings.

Falcon Way is located less than 0.1 miles from Mudchute DLR station (7 mins to Greenwich and 11

mins to Canary Wharf). Canary Wharf Underground and the Elizabeth Line service for high-speed connection pan throughout the Capital is available for a scenic 1.1 mile walk along Millwall Outer and Inner docks to Canary Wharf Jubilee Line station.

As well as fabulous dock views, the apartment is also close to plenty of green spaces, including Millwall Park and Mudchute Park and farm.

Tenure:	Leasehold (961 years remaining)	Local Authority:	Tower Hamletts
Ground Rent:	£100 p.a.	Council Tax Band:	D
Service Charge:	Approx. £3,300 p.a.	EPC:	C



Floorplan

618 sq ft | 57.4 sq m

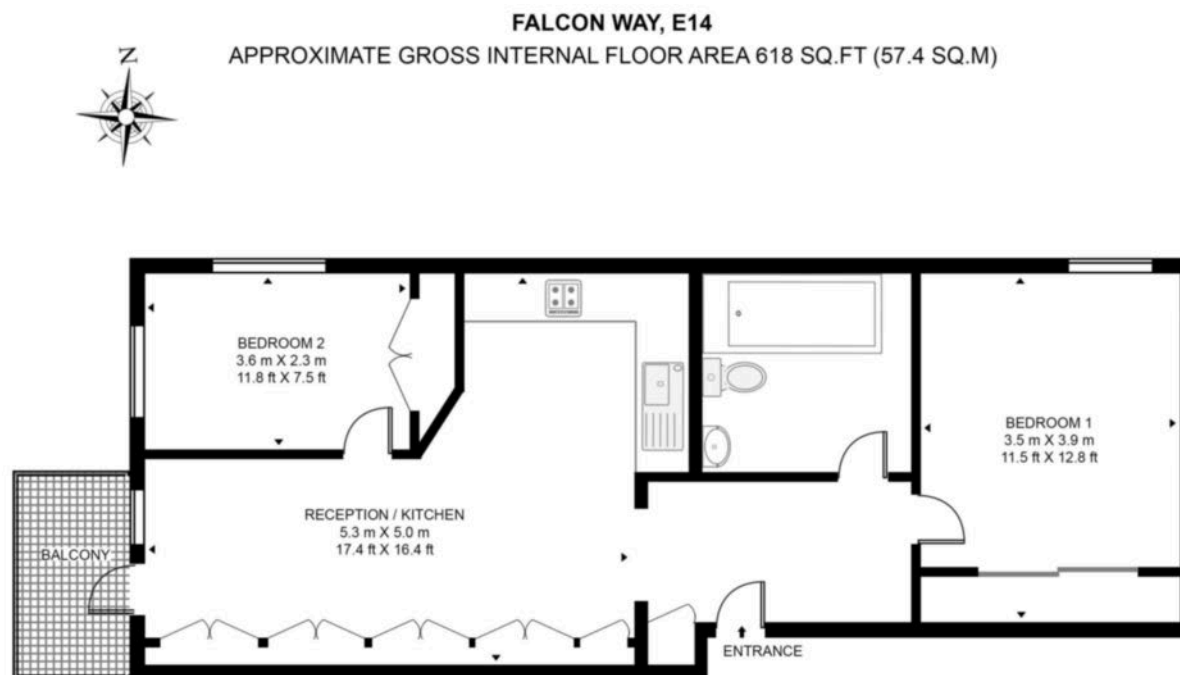

Whilst every attempt has been made to ensure the accuracy of the floor plan contained here, measurements of door, windows, rooms and any other items are approximate and no responsibility is taken for any error, omission, or mis-statement. The plan for illustrative purposes only and should be used as such by any prospective purchaser. The services, system and appliances shown have not been tested and no guarantee as to their operability or efficiency can be given.

Pan Peninsula

Pan Peninsula, 1 Millharbour, London, E14 9XP

Sales

020 7536 7901 | panp.sales@chaseevans.com

We're here to help.

IMPORTANT NOTICE - These particulars have been prepared in good faith and they are not intended to constitute part of an offer or contract. We have not performed a structural survey on this property and the services, appliances and specific fittings have not been tested. All photographs, measurements, floor plans and distances referred to are given as a guide and should not be relied upon.

chaseevans.com

 Chase Evans