

Poplar Grove, New Southgate

£276 PW

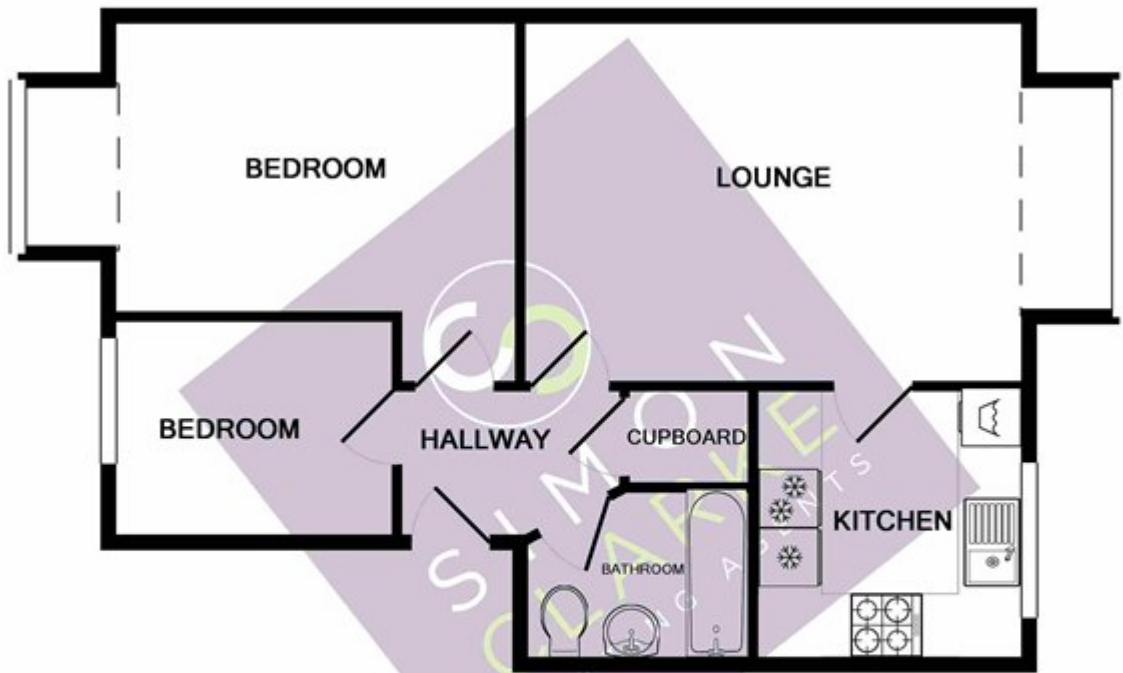

TOTAL APPROX. FLOOR AREA 571 SQ.FT. (53.0 SQ.M.)

Whilst every attempt has been made to ensure the accuracy of the floor plan contained here, measurements of doors, windows, rooms and any other items are approximate and no responsibility is taken for any error, omission or mis-statement. This plan is for illustrative purposes only and should be used as such by any prospective tenant. The services, systems and appliances shown have not been tested and no guarantee as to their operability or efficiency can be given. Simon Clarke Letting Agents.
Made with Metropix ©2017