

Clyde Square, London

OIEO £350,000 Leasehold

Royal Quay, E14
Approximate Gross Internal Area = 37.2 sq m / 400 sq ft

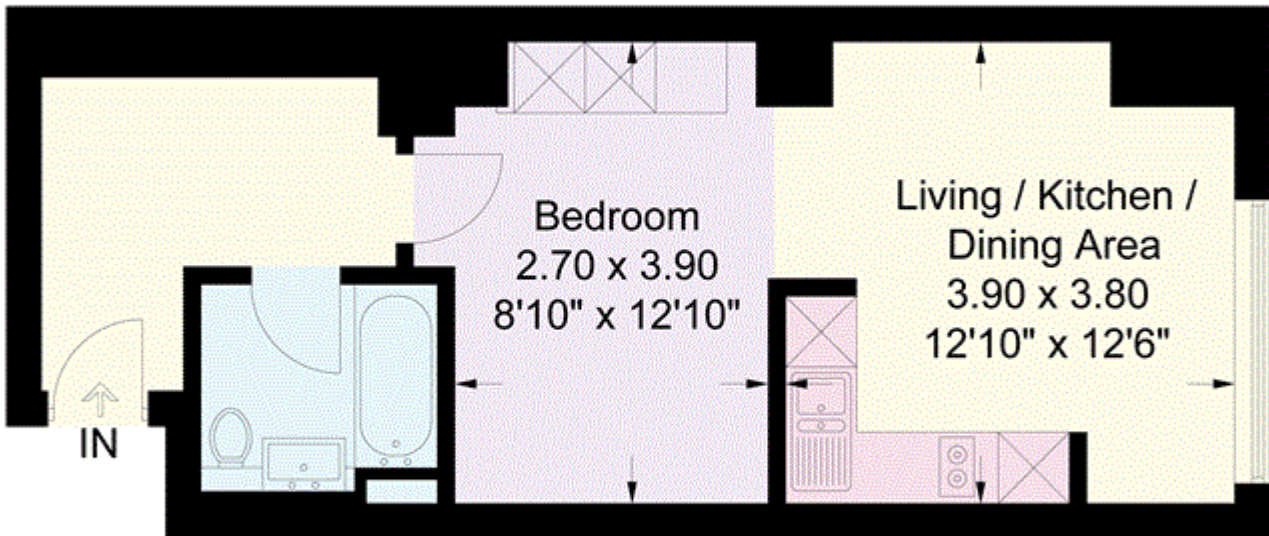

Chase Evans make every attempt to ensure accuracy, however all measurements are approximate.
All aspects of this floor plan are for illustrative purposes only and not to scale. Errors and omissions excepted (E&OE).