

Wandsworth Road, London

£880,000 Leasehold

---

**Sky Gardens, Nine Elms, SW8**

Approximate Gross Internal Area = 67.9 sq m / 731 sq ft

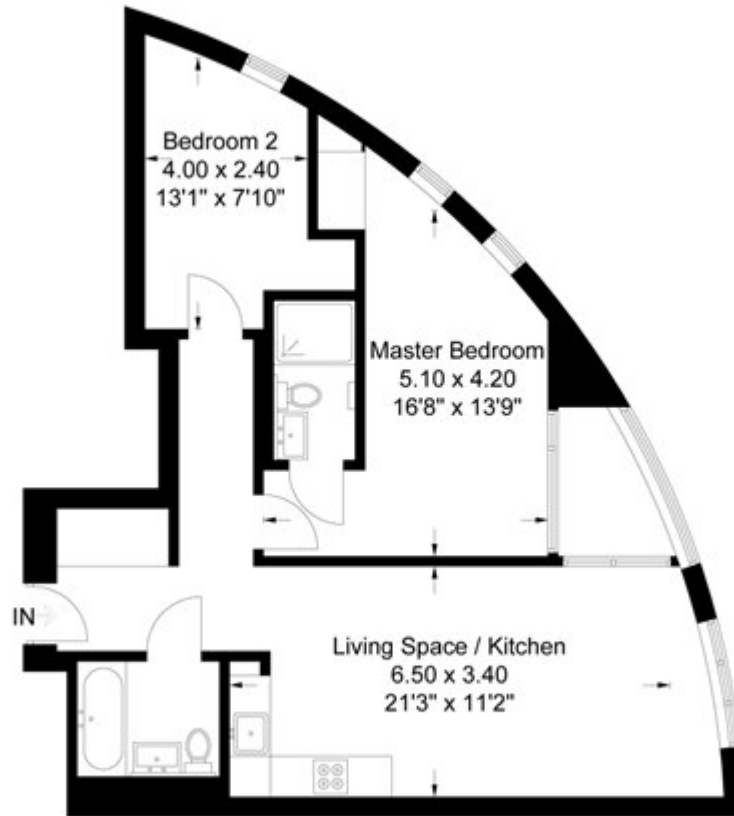

Chase Evans makes every attempt to ensure accuracy, however all measurements are approximate.  
All aspects of this floor plan are for illustrative purposes only and not to scale. Errors and omissions excepted (E&OE).