

Hilltop Avenue, London

OIRO £300,000 Leasehold

Spring, Camellia Apartments, Stonebridge, NW10

Approximate Gross Internal Area = 51.1 sq m / 551 sq ft

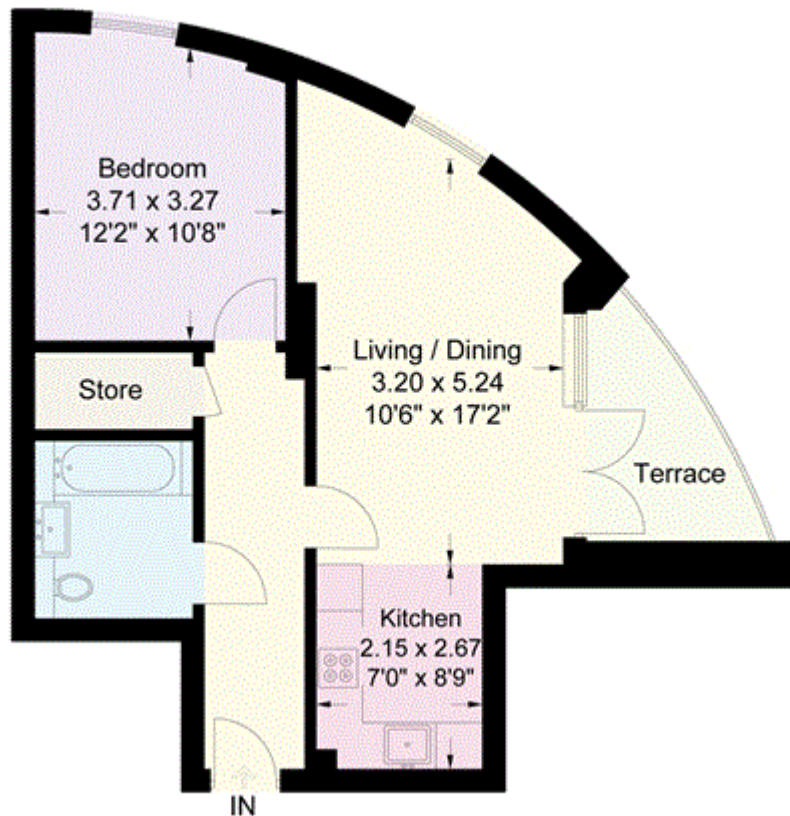

Chase Evans make every attempt to ensure accuracy, however all measurements are approximate.
All aspects of this floor plan are for illustrative purposes only and not to scale. Errors and omissions excepted (E&OE).