

Peartree Way, London

£380,000 Leasehold

---

Canary Skyline, Greenwich Millennium Village 2, SE10

Approximate Gross Internal Area = 53.0 sq m / 570 sq ft

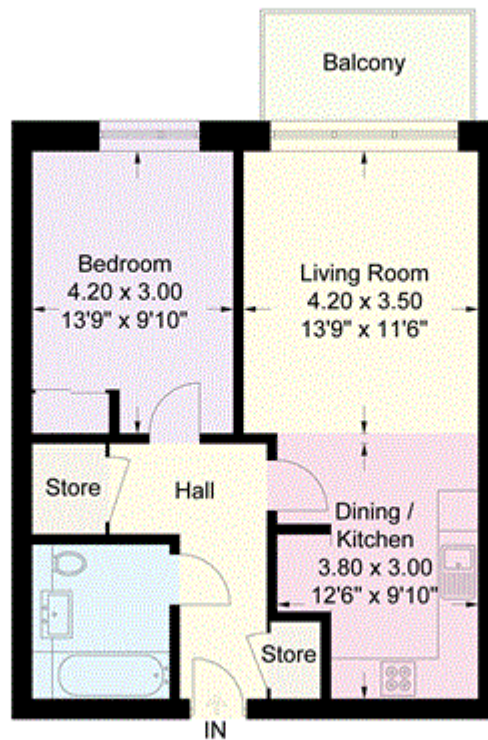

Chase Evans make every attempt to ensure accuracy, however all measurements are approximate.  
All aspects of this floor plan are for illustrative purposes only and not to scale. Errors and omissions excepted (E&OE).