

# Queenshurst Square, London

£600 PW

Hamond Court, Queenshurst Square, KT2  
Approximate Gross Internal Area = 71.9 sq m / 774 sq ft

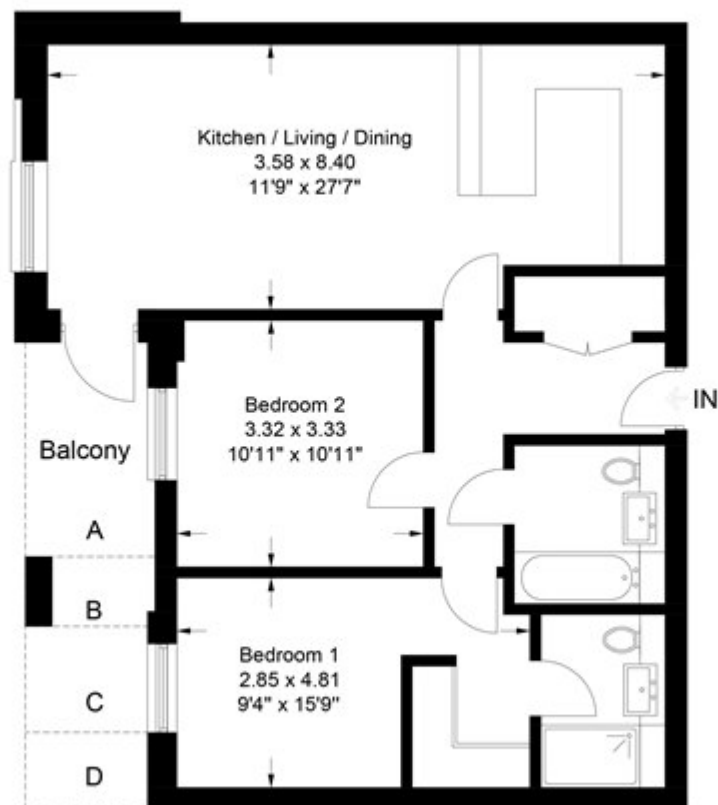

Chase Evans makes every attempt to ensure accuracy, however all measurements are approximate.  
All aspects of this floor plan are for illustrative purposes only and not to scale. Errors and omissions excepted (E&OE).