

Pan Peninsula Square, London

£325,000 Leasehold

Pan Peninsula, Canary Wharf, E14

Approximate Gross Internal Area = 28 m / 301 sq ft

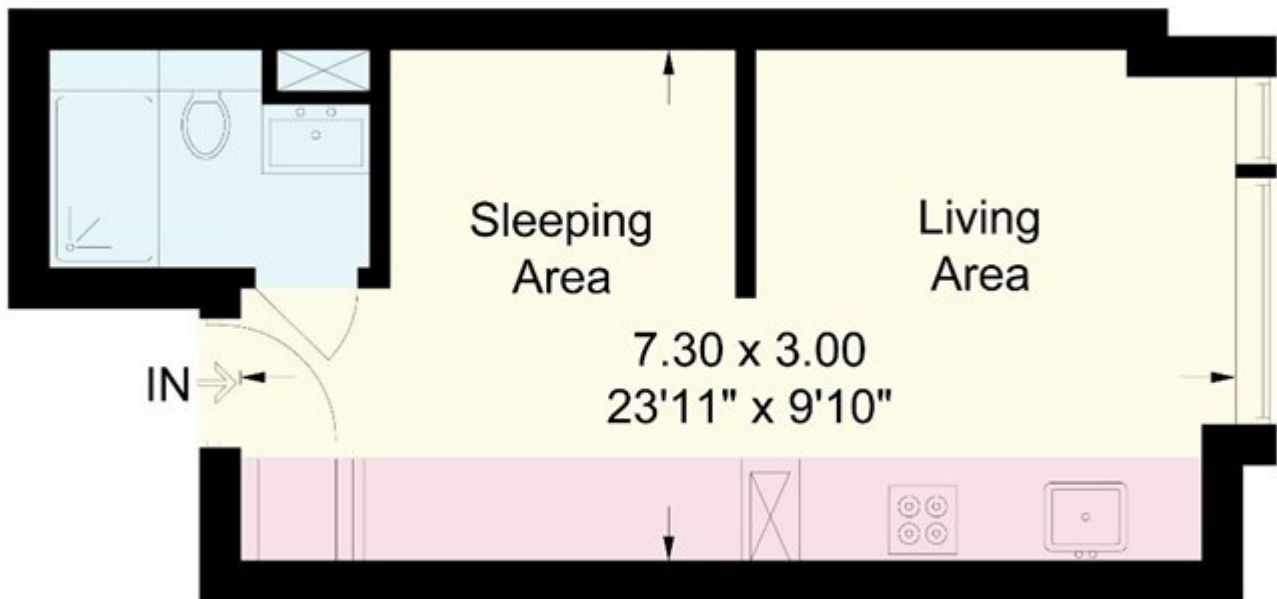

Chase Evans make every attempt to ensure accuracy, however all measurements are approximate. All aspects of this floor plan are for illustrative purposes only and not to scale. Errors and omissions excepted (E&OE).