

Pan Peninsula Square, London

£525 PW

Pan Peninsula Square, Canary Wharf, E14

Approximate Gross Internal Area = 46.7 sq m / 502 sq ft

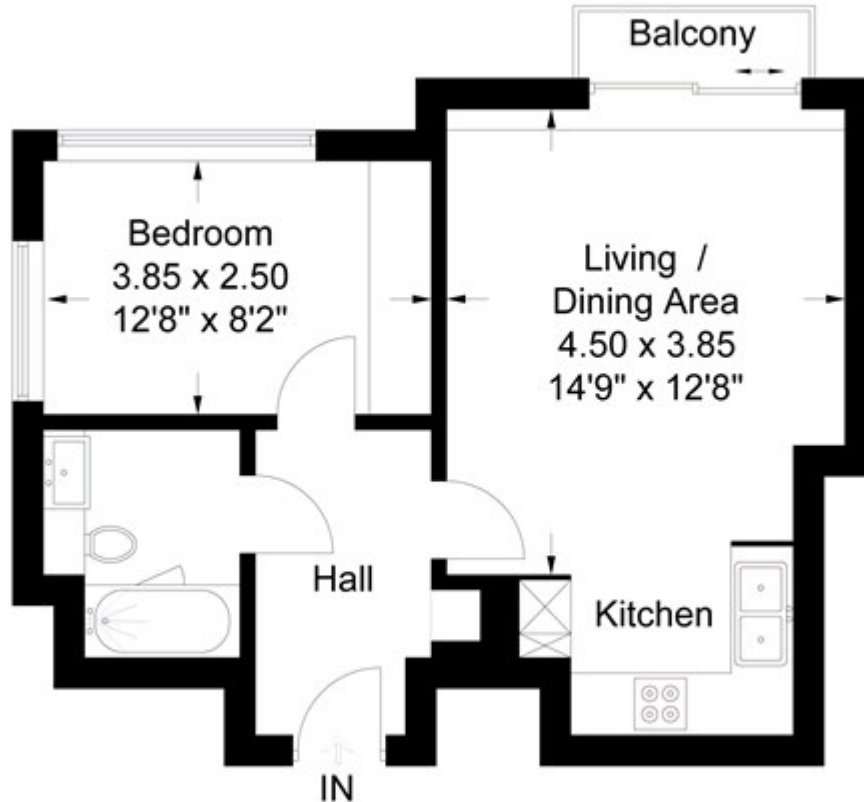

Chase Evans make every attempt to ensure accuracy, however all measurements are approximate.
All aspects of this floor plan are for illustrative purposes only and not to scale. Errors and omissions excepted (E&OE).