

Central Avenue, London

£535 PW

Ingrebourne Apartments,  
Fulham Riverside,  
Central Avenue, SW6  
Approx. Gross Internal Area  
592 Sq Ft - 55.00 Sq M

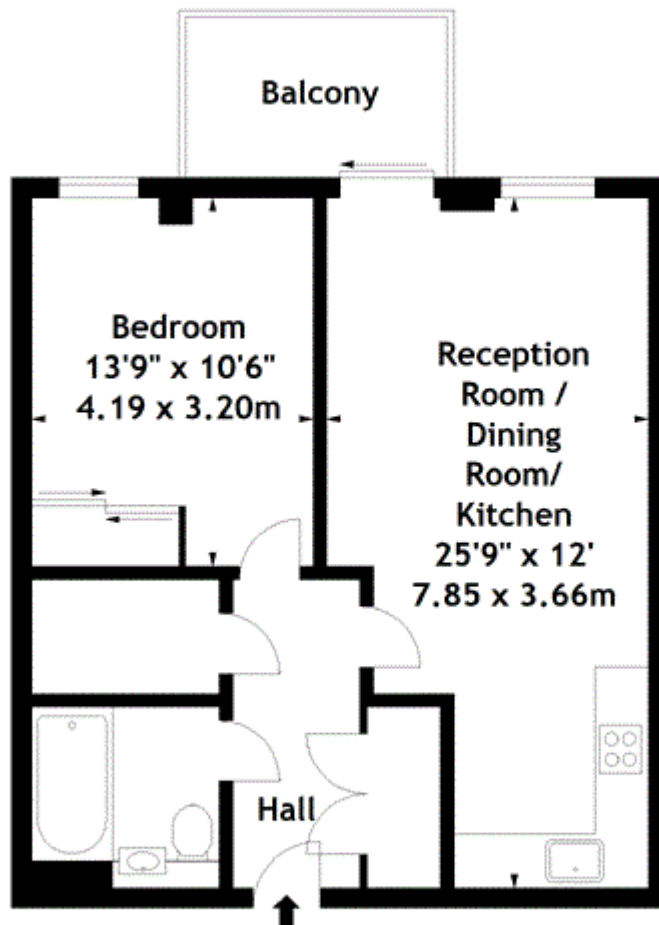

### Fifth Floor

Measured in accordance with RICS guidelines. Every attempt is made to ensure accuracy, however all measurements are approximate. This floor plan is for illustrative purposes only and is not to scale.

© Datagraphy Ltd 2014

Photographs \* Floorplans \* Virtual Tours  
Tel: 0845 643 4401 [www.datagraphy.com](http://www.datagraphy.com)