

# Westward Close, Chichester

Guide price £425,000 Freehold

---

## Westward Close, Bosham, PO18 8QX

Approximate Gross Internal Area = 103.8 sq m / 1117 sq ft



Produced for Stride & Son Estate Agent.

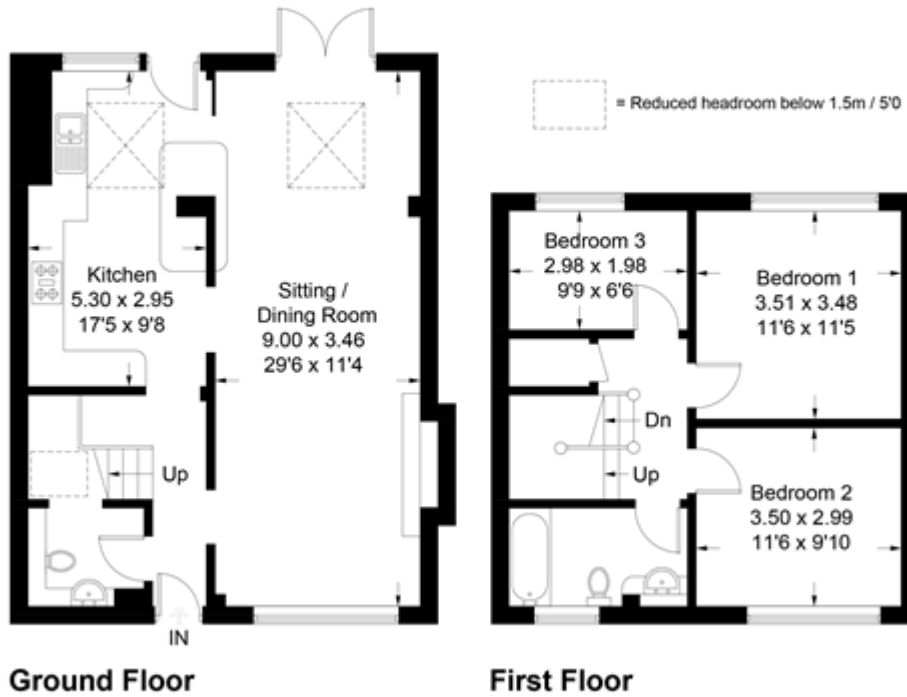

Whilst every attempt has been made to ensure the accuracy of the floor plan contained here, measurements of doors, windows, rooms and any other items are approximate and no responsibility is taken for any error, omission, or misstatement. This plan is for illustrative purposes only and should be used as such by any prospective purchaser.  
Created by Emzo Marketing 2018. (ID484658)